

GF NO. 01-305197 FIDELITY NATIONAL TITLE
ADDRESS: 13918 SOMERSWORTH DRIVE
HOUSTON, TEXAS 77041
BORROWER: CESAR HUMBERTO AND
VANESSA M. GARCIA

LOT 3, BLOCK 8 CONCORD BRIDGE, SECTION 6, PARTIAL REPLAT

ACCORDING TO THE MAP OR PLAT THEREOF
RECORDED UNDER FILM CODE NO. 353125 OF THE MAP
RECORDS OF HARRIS COUNTY, TEXAS



WEST LITTLE YORK ROAD
(100' R.O.W.)

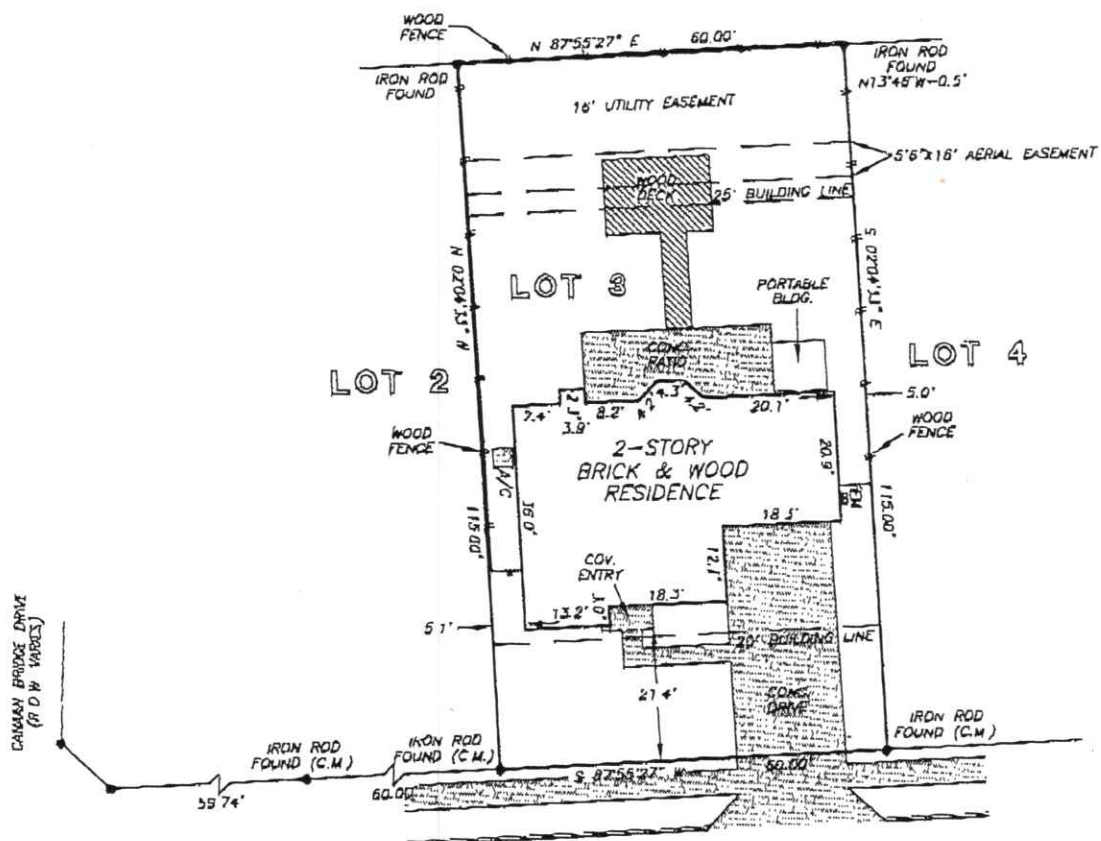

SOMERSWORTH DRIVE
(30' R.O.W.)

NOTE: AGREEMENT BY AND BETWEEN DEVELOPER AND H. L. & P.
FOR INSTALLATION OF OVERHEAD/UNDERGROUND ELECTRICAL
DISTRIBUTION SYSTEM AS PER HCCF NO. M773804.

THIS PROPERTY DOES NOT LIE WITHIN THE
100 YEAR FLOOD PLAIN AS ESTABLISHED
BY THE U.S. DEPT. OF HOUSING & URBAN
DEVELOPMENT.
COMMUNITY/PANEL NO. 48201C 0630 J
MAP REVISION: 11/6/96
ZONE X

I HEREBY CERTIFY THAT THIS SURVEY WAS MADE
ON THE GROUND, THAT THIS PLAT CORRECTLY
REPRESENTS THE FACTS FOUND AT THE
TIME OF SURVEY AND THAT THERE ARE NO
ENCROACHMENTS APPARENT ON THE GROUND,
EXCEPT AS SHOWN HEREON. THIS SURVEY IS
CERTIFIED FOR THIS TRANSACTION ONLY AND
ABSTRACTING PROVIDED IN THE ABOVE
REFERENCED TITLE COMMITMENT WAS RELIED
UPON IN PREPARATION OF THIS SURVEY.

RECORD BEARING: FILM CODE NO. 353125, H.C.M.R.

PRECISION SURVEYORS
PROFESSIONAL LAND SURVEYS

1-800-LANDSURVEY 281-496-1586
1-800-526-3787 FAX 281-496-1867

14825 MEMORIAL DRIVE SUITE 8100 HOUSTON, TEXAS 77078

Billie G. McDuffie
BILLIE G. MCDUFFIE
PROFESSIONAL LAND SURVEYOR
NO. 2090
DRAWING NO. 01-0414
JANUARY 25, 2001



DRAWN BY: JG