

# Building Sketch

Borrower				
Property Address 10726 Tupper Lake Dr				
City	Houston	County	Harris	State TX Zip Code 77042
Lender/Client Lesley Lively Koerner				

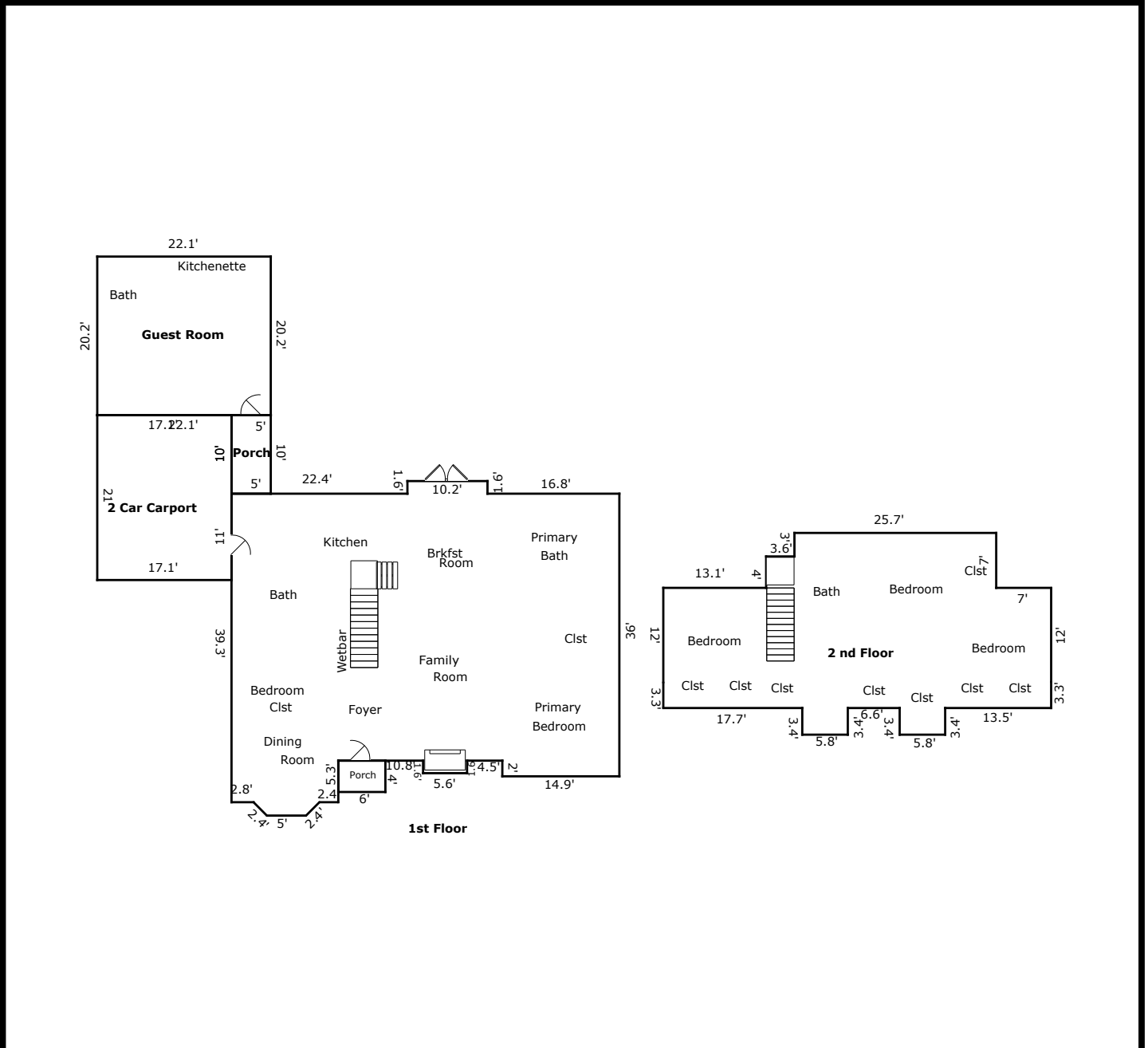

TOTAL Sketch by a la mode, inc.

### Area Calculations Summary

Living Area	Calculation Details
1st Floor	$10.2 \times 1.6 = 16.32$ $0.5 \times 1.7 \times 1.7 = 1.44$ $0.5 \times 1.7 \times 1.7 = 1.44$ $5 \times 1.7 = 8.5$ $5.6 \times 1.6 = 8.96$ $49.4 \times 34 = 1679.6$ $2 \times 14.9 = 29.8$ $5.3 \times 13.6 = 72.08$
2 nd Floor	$5.8 \times 3.4 = 19.72$ $5.8 \times 3.4 = 19.72$ $49.4 \times 15.3 = 755.82$ $4 \times 3.6 = 14.4$ $25.7 \times 7 = 179.9$
<b>Total Living Area (Rounded):</b>	<b>2808 Sq ft</b>
<b>Non-living Area</b>	
Guest Room	$20.2 \times 22.1 = 446.42$
2 Car Carport	$17.1 \times 21 = 359.1$
Porch	$5 \times 10 = 50$
Porch	$4 \times 6 = 24$