

END-O-PEST AND COASTAL FUMIGATORS

FACSIMILE TRANSMITTAL SHEET

TO: Mk & Ms Kaplan FROM: CHUCK DOMEL
COMPANY: _____ DATE: 6/11/21
FAX NUMBER: _____ TOTAL NO. OF PAGES INCLUDING COVER: _____
PHONE NUMBER: 713 398 4767 OFFICE NUMBER: 713-863-7378/CELL 281-455-3800
RE: 1015 Allston FAX NUMBER: 713-863-0143
EMAIL: _____ EMAIL: coastalfume@gmail.com

ERIN KAPLAN @ compass.com
URGENT FOR REVIEW PLEASE COMMENT PLEASE REPLY PLEASE RECYCLE

NOTES/COMMENTS:

7 pages sign & also initial
the 2 boxes

— please see graph for prep needs —
quite a bit

A 60' MANLIFT IS NEEDED TO
ACCESS ROOF & IS AN

ADDITIONAL \$866⁰⁰

****IF A CHERRY PICKER IS REQUIRED TO DO FUMIGATION, THE CONSUMER
WILL BE RESPONSIBLE FOR COST OF CHERRY PICKER RENTAL****

Handwritten signature/initials



COASTAL FUMIGATORS INC.

713-863-7378 (PEST)
1119 West 34th St.
Houston, Texas 77018
TPCL #6856
R.C.A. 34261

DRYWOOD TERMITE SERVICE AGREEMENT

Treatment Date: _____ C# _____ R# _____

Customer's Name: _____

Covered Premises (Address) 1015 Allston

Billing Address _____

City HOUSTON State TX Zip Code 77008

Telephone No (Home) _____ (Office) _____ (Other) _____

TREATMENT: This agreement covers only the premises specified above and included on the graph sheets. Type of treatment is for drywood termites only. (Note graph) Coastal Fumigators agrees to exercise reasonable care in the application of any treatment to avoid damage to the roof, gutters, shrubs or vegetation, and will not be responsible for damage to the roof, gutters, shrubs or vegetation unless said damage results directly from Coastal Fumigators gross negligence.

COVERAGE: For a period beginning on the date of treatment, and ending on the last day of the month preceeding the month in which the first anniversary of the date of treatment occurs, COASTAL FUMIGATORS agrees to provide necessary service and treatment for the control of drywood termites (KALOTERMES) to the covered premises for the sum of \$ 3972.00 plus sales tax of \$ 327.69 for a total of \$ 4299.69 which is due upon arrival of fumigation crew at the service address. Should CUSTOMER fail to make payment in full, in accordance with a pre-arranged schedule, CUSTOMER agrees to pay additional finance charges of 18% per annum (1.5% per month).

RETREATMENT: If drywood termite re-infestation occurs to the covered premises while this agreement is in effect, then Coastal Fumigators will, upon notification and inspection, arrange for necessary retreatment at its expense. **COASTAL FUMIGATORS DOES NOT ACCEPT ANY LIABILITY FOR ANY DRYWOOD TERMITE DAMAGE REPAIR.** Any re-treatment obligation hereunder covers only the woodwork of the building treated under the initial treatment. In the event the treated building is structurally modified, altered or otherwise changed after the date of the initial treatment, the retreatment obligation of Coastal Fumigators shall terminate unless a prior written agreement is entered into between Owner and Coastal Fumigators to provide for such additional treatment, if necessary, of said areas, and/or an adjustment to the annual renewal fee is agreed upon between Owner and Coastal Fumigators. Should the customer request an inspection not due to reinfestation, there will be a "Trip Charge" at the current trip charge rate.

RENEWAL: This agreement is renewable by customer by payment of an annual renewal fee of \$ 397.00 plus sales tax. The annual renewal fee must be paid each year before the first day of the month in which occurs the anniversary of the original treatment date. **This agreement may be terminated by either party with or without cause.** It is the customer's responsibility to correct conducive conditions to the covered property in order for Coastal Fumigators to continue to renew this service agreement. Coastal Fumigators does not crawl any premise during the renewal process.

COASTAL FUMIGATORS reserves the right to modify the price of renewal after the second year due to increased costs, inflation, etc.

TRANSFER: This agreement may be transferred to a new owner of the covered premises by payment of the current transfer fee within thirty (30 days of closing date). At that time the annual renewal date will change to the first day of the month in which the transfer date occurs.

MEDIATION: All controversies arising under or in connection with, or relating to any alleged breach of the Agreement shall be attempted to be settled by Mediation, utilizing an agreed upon Mediator. The CUSTOMER and COASTAL FUMIGATORS shall share equally in the cost of the Mediator, regardless of outcome, finding or recommendation.

Each party shall pay its own costs, expenses, and legal fees incident to this Agreement and the transaction contemplated hereby, whether or not this Agreement and such transactions shall be consummated.

Should both parties be unable to reach an acceptable Agreement during Mediation, CUSTOMER and COASTAL FUMIGATORS, hereby agree to enter into Arbitration.

ARBITRATION: Any dispute arising out or relating to this agreement or the services performed under this agreement or tort based claims for personal or bodily injury or damage to real or personal property shall be finally resolved by Arbitration administered under the commercial arbitration rules of the American Arbitration Association. This agreement involves interstate commerce; furthermore the parties expressly agree that their mutual rights and obligations & the conduct of any arbitration proceeding shall be controlled by the Federal Arbitration Act. The award of the Arbitrator shall be final, binding, non-appealable and may be entered and enforced in any court having jurisdiction in accordance with the Federal Arbitration Act. The Arbitrator shall have the power or authority to award exemplary, treble, liquidated or any type of punitive damage.

SPECIAL AGREEMENT: COVERS HOUSE & DETACHED GARAGE
APT. FOR DRYWOOD TERMITES ONLY (KALOTERMES)

Coastal Fumigators is licensed and regulated by: Texas Department of Agriculture,
P.O. Box 12847 • Austin, Texas 78711-2847 • Phone: 866-918-4481 (Fax) 888-232-2567

COASTAL FUMIGATORS will not be responsible for treatment of SUBTERRANEAN TERMITES (RETICULITERMES) or FORMOSAN TERMITES (COPTOTERMES).

Authorized Representative _____ CA# _____ Customer Signature _____ Date _____



COASTAL FUMIGATORS INC.

713-863-7378 (PEST)
1119 West 34th St.
Houston, Texas 77018
R.C.A. 34261

CUSTOMER'S DUTIES IN PREPARING FOR TENT FUMIGATION

1. All persons, pets, and plants must be removed.
2. All alcohol and tobacco products must be removed. Food, medicines and beverages not in factory sealed glass or metal containers must be removed. Cosmetics, skin care products and dental hygiene products must be removed. No alcohol, in any container, should remain in the house.
3. Water-proof mattress covers and baby mattresses must be removed.
4. All food in refrigerators and freezers must be removed.
5. Dishes and utensils need not be removed or washed, structural fumigants are colorless, odorless and will not affect paints, finishes or fabrics.
6. **Additional items to be removed include ice cubes, water coolers, cars in garage and driveway, bear bag chairs, and alarms disarmed. CARS ARE TO BE MOVED 50' FROM HOUSE.** INITIAL
7. **Natural gas must be turned off at the meter. Coastal Fumigators will not be responsible for re-lighting pilot lights. Contact your local plumber at customer expense.**
8. All heating elements must be unplugged (pianos, organs, etc.).
9. All automatic timing devices (sprinklers, lights, etc.) must be disconnected.
10. We must have access to electricity for our own use of fans to circulate fumigant. We also use measuring devices for proper control of fumigant.
11. As a safety precaution, fumigator must have access to all parts of the structure. This includes storerooms, closets, etc. which are normally kept locked. Safes must be empty and left open.
12. Any plants closer than 12 inches to the building or vines attached to the building must be removed, or cut back to provide enough space so tent can fall freely to the ground. Tree limbs over roof must be trimmed back. Decorative bark, gravel, rocks, etc. must be raked back 12 inches from the building. Bird baths, potted plants, patio furniture etc., must be relocated ten feet from the structure.
13. Soil should be soaked 6 inches deep, 1 foot outward from foundation on day before scheduled fumigation.
14. **Care will be taken to avoid any damage to roof. During fumigation some roof damage may be unavoidable. This company will assume no responsibility for any roof or gutter damage.** INITIAL
15. Antennae, satellite dishes, weather vanes or any item attached to the structure must be removed by owner or occupant. Fences must be detached from the structure. Gutters may be bent in the tenting process - if owner wishes 2x4's may be added for support.
16. Our crews must fumigate several structures in various locations each day, therefore the time any fumigation is scheduled must be approximate.
17. Fumigation operations may not commence during inclement weather (high winds, rain, etc.) or temperatures below 40° Fahrenheit and have to be rescheduled. This company will assume no responsibility for fees for lodging or kennels.
18. During the fumigation procedure and aeration period, this company will not be held responsible for vandalism, theft or breaking and entering. A guard will be posted after the gas has been administered and will remain on site until the aeration period begins. After this company has locked and secured the structure, there will not be a guard present.
19. This building will be fumigated with POISONOUS GASES. All persons and pets must vacate the premises when the fumigation crew arrives. Under no circumstances can anyone enter the building until the fumigation notice is posted giving the time & date for safe entry.
20. Payment and keys to all exterior and interior doors must be in Coastal Fumigators' possession before the fumigation will begin.

I have read this instruction sheet and understand that it is my responsibility to have these things done before the fumigation crew arrives. The fumigation crew will not remain on site until the above preparations are met in full. I understand there is an additional charge of \$250.00 + tax if preparation is not complete upon the arrival of the fumigation crew.

DATE _____

PLEASE SIGN & RETURN X

PROPERTY ADDRESS 1415 AILSTON

ALSO 6017

FUMIGATION CANNOT COMMENCE WITHOUT THIS SIGNED NOTICE IN FUMIGATOR'S POSSESSION.

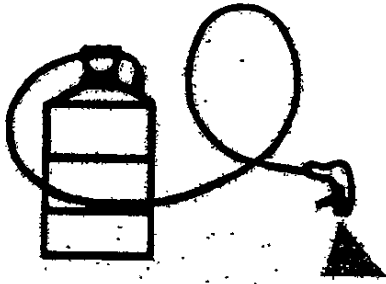

Coastal Fumigators END-O-PEST

TERMITE AND PEST CONTROL

PET CARE FOR FUMIGATION

Property Address: 1015 Alston
Dates: _____ to _____

I DO NOT have a Pet Cat* _____

I DO have a Pet Cat(s)** _____ Number of Cats? _____

On the day of my fumigation and throughout the fumigation process, my pet(s) will be:
In my possession and away from the home _____
Boarded in a Kennel _____

As you prepare your home for its upcoming fumigation, we wanted to remind you of your other family members, your pets. The fumigation process, beginning when you start to prepare your home, may cause your pet(s) to be upset and hide, sometimes making them impossible to find prior to the home being fumigated. You also may become so distracted in completing preparations that you forget to remove the pet prior to the fumigation. Cats in particular are unique pets as they have a tendency to come and go as they please. Unlike a dog, cats prefer to be left with little or no attention to them. Having this freedom causes a variety of reaction when they become stressed. As their environment changes or as a stranger enters their territory, your cat may act odd or run and hide in a familiar place, or they might find a new hiding place. In order to avoid the loss of a loved pet, our company hopes to prevent this from happening, and we wish to remind you to remove your pet from the property during the fumigation process.

*Even if you do not own a cat, you may have a neighbor whose pet roams the neighborhood. To help reduce the chances of their pet entering the structure during the fumigation process, we strongly recommend that you communicate your fumigation dates with your neighbors and close off any openings or spaces that would allow domestic animals access, such as crawl spaces, access openings or vents.

*Our fumigation company utilizes chloropicrin (tear gas) as a warning agent with the Vikane gas during fumigation. The Vikane label states: "Remove from the structure to be fumigated all persons, domestic animals, pets (including fish) and desirable growing plants." Cats are capable of ignoring the extreme physical distress of chloropicrin exposure and will not leave their hiding place to alert a fumigator of their presence before the Vikane gas is introduced. We depend on you to help prevent a tragedy from occurring.

Signature _____

Date _____

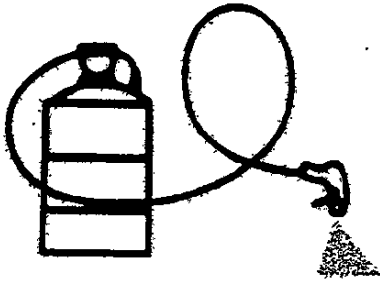

Coastal Fumigators

END-O-PEST

TERMITE AND PEST CONTROL

Spray Foam Attic Insulation

Property address: 1215 Ailston

Does the structure's attic to be fumigated have spray foam insulation? *



No Yes



*ADDITIONAL TIME WILL BE NEEDED FOR PROPER AERATION. THIS MAY EXTEND YOUR RELEASE DATE.

~~X~~

Customer Signature

Date





COASTAL FUMIGATORS
END-O-PEST
TERMITE & PEST CONTROL

713-863-7378 (PEST)
1119 West 34th St.
Houston, Texas 77018

CONSUMER DISCLOSURE STATEMENT
Wood Destroying Insects (W.D.I)

Regulations by the Texas Department of Agriculture require that before conducting a termite treatment, the pest control company proposing the treatment shall present the prospective customer with a disclosure statement containing the following information.

1. A graph and description of the structure or structures to be treated including:
 - a. The address or location.
 - b. A graph showing:
 - (1) Approximate measurements as accurately as possible.
 - (2) Construction details needed for clarity of the report.
 - (3) Areas of present W.D.I. activity.
 - (4) Areas of previous W.D.I. activity.
 - (5) Areas of W.D.I. damage.
 - (6) Areas of conditions conducive to infestation by W.D.I.
 - c. The type of construction:
 - (1) foundation: slab, pier & beam, basement, etc.
 - (2) siding: wood, brick, stone, etc.
 - (3) roof: composition, wood, metal, etc.
 - (4) primary use: residence, public, commercial, industrial, etc.
2. The name of the pesticide (s) to be used and a label for any pesticide recommended or used.
3. The complete details of the service agreement provided, including:
 - a. If the service agreement does not include the entire structure treated, a list of the areas excluded.
 - b. The time period of the service agreement.
 - c. The renewal options and cost.
 - d. Any obligations accepted by the pest control company to retreat for termite infestations within the service agreement period.
 - e. Any obligations accepted by the pest control company to repair damage caused by termites within the service agreement period.
 - f. Conditions that could develop as a result of the owner's action or inaction that would void the service agreement.
4. The signature of approval by a certified applicator in the termite category employed by the company making the proposal.

END-O-PEST / COASTAL FUMIGATORS is licensed and regulated by the Texas Department of Agriculture Structural Pest Control Service, P.O. Box 12847, Austin, Texas 78711-2847
(866) 918-4481 Fax: (888) 232-2567

I acknowledge receipt of the above information and understand the details of the service agreement.

Date: _____

Customer Signature: _____

Address: 1915 Alston

Cert. Appli. Signature: _____

CONSUMER INFORMATION SHEET

The structural pest control industry is regulated by the Texas Department of Agriculture (TDA), Structural Pest Control Service (SPCS), P.O. Box 12847, Austin, Texas 78711-2847. TDA licenses the businesses, certified applicators and technicians who perform structural pest control work. Certified applicators and technicians must pass a written examination in order to receive their licenses.

Pesticides must be registered with the United States Environmental Protection Agency (EPA) and the TDA before they may be used in Texas. EPA registration is not a finding of product safety. Pesticides are designed to kill or control pests. Your risk of harm depends upon the degree of your exposure and your individual susceptibility.

Specific health and safety information varies between pesticides and types of exposures and is available on the label information or MSDS sheet which can be supplied to you upon request from the licensed applicator. Take precautions when a treatment has been performed to avoid exposure to vulnerable individuals. Pesticides may be harmful if swallowed, inhaled, or absorbed through the skin. Avoid breathing dust or spray mist and any unnecessary contact with treated surfaces. If you desire specific information on precautions, refer to the pesticide label. The law requires that the application procedures specified on the label be followed.

If you have questions about the application, contact the business or person making the application. If you suspect a violation of the law regarding structural pest control, contact the SPCS. In case of a health emergency, seek immediate medical attention.

Pest control signs must be posted prior to treatment in many instances. The signs should be posted in an area of common access at least 48 hours prior to treatment. The information sign will allow you to contact someone who can tell you what pesticide is being used.

If you are contracting for pest control services due to a home solicitation, you have the right to cancel the contract within 72 hours. You may exercise this right by notifying the pest control company that you do not wish to receive their service.

For general information on pesticides, contact: National Pesticide Information Center 1-800-858-7378

For information concerning structural pest control laws, contact the Structural Pest Control Service at: (866) 918-4481

For information concerning the formulation and registration of pesticides, contact the TDA pesticide registration at: (512) 463-7476 or (800) 835-5832

For non-emergency health information relating to pesticides, contact Texas Department of State Health Services (512) 458-7111.

REDUCED IMPACT SERVICE

In order to minimize the reliance on pesticides and reduce pest populations, a Reduced Impact Pest Control operator may recommend that you consider the sanitation or physical alteration of your work place or residence. It is your responsibility to follow those recommendations. Your pest control operator may or may not offer these services upon request. A proper inspection will provide the information necessary for you to choose the method of pest control which best suits your situation. Many pest problems can be solved without using pesticides.

This Reduced Impact Service will include an inspection report and treatment recommendations. You should review these and keep a copy for your records. Your cooperation in following the recommendations made by your service provider is essential to a reduced impact service program.

Pesticides may be used in a responsible and professional manner in a reduced impact pest control service. If you do not want a specific pesticide used or any pesticides used at all, you must note this in writing on the contract prior to the initiation of the service. If any specific pesticide or class of pesticides are not excluded, it may be used by the provider.

Vikane® Gas Fumigant

Nervous System And Respiratory Irritation

Overexposure to high levels of Sulfuryl fluoride can result in nose and throat irritation and nausea. At high concentrations (such as those used during the fumigation) it can cause excess fluid in the lungs, sleepiness, pneumonia, and convulsions. These symptoms would be expected to appear within 8 hours after such an exposure. In the unlikely event you experience these symptoms in the building that has been recently fumigated, you should leave immediately. Consult your physician and call the pest control company to have your building retested.

Additional Studies

Sulfuryl fluoride has not been shown to cause birth defects in pregnant animals exposed under experimental conditions. In addition, current studies have demonstrated there are not mutagenic or genotoxic effects caused by exposure to Sulfuryl fluoride.

Questions

If you have specific questions about your fumigation, refer to documents provided by the fumigator or call the fumigator listed on the warning signs posted on your structure. Call the Douglas Products Customer Information Center at 844-8VIKANE (844-884-5263) if you need additional information or have questions concerning this product.

Safety Precautions And Homeowner Preparation

- Discuss the treatment program in advance with your pest control company so you fully understand what will be done and what you need to do.
- Carefully follow the instructions you are given about what items you are to remove from your building.
- Stay out of the treated building until it is cleared by your pest control company for reentry.
- If you are interested or concerned, you should ask your pest control company to show the records of how your building was aerated before it was cleared for reentry.
- You may wish to increase ventilation by opening doors and windows.

DATE: _____

PROPERTY ADDRESS: 1015 Allston

CUSTOMER'S SIGNATURE: X

TermiteTenting.com



*Trademark of Douglas Products.
Vikane is a federally Restricted Use Pesticide. Always read and follow label directions.
These materials have been created specifically for Vikane gas fumigant and no other structural fumigant. These materials may not be copied, in whole or in part, or reproduced without the permission of Douglas Products.
U01-069-146 (5/16) BR



VIKANE®

Fact Sheet For Vikane® Gas Fumigant (Sulfury Fluoride)

Vikane® Gas Fumigant

In the interest of Douglas Products' commitment to product stewardship, this fact sheet is intended to provide basic information about the product and how it is used. If you have specific questions about your fumigation, refer to documents provided by the fumigator or call the fumigator listed on the warning signs posted on your structure. If you have questions about Vikane gas fumigant (the fumigant used) or the procedures described, call the Douglas Products Customer Information Center at 844-8VIKANE (844-884-5263).

Why Buildings Are Fumigated

Insects that feed or tunnel into wood can seriously damage houses, apartments, and other dwellings or structures. Each year termites or other wood destroying insects damage more than 5 million homes. Other pests, such as bed bugs, may be dispersed throughout rooms and can be difficult to locate and control quickly and completely. Depending on the extent or location of the infestation, fumigation is the only total control method proven to eliminate certain infestations of wood destroying insects, bed bugs and other structure-infesting pests.

How Buildings Are Fumigated

Because Vikane is a gas, prior to fumigation, the structure is completely sealed. This serves to contain Vikane in the building so it can penetrate wood and building contents to thoroughly eliminate the pests. Depending on the construction of the building, the doors and windows may be sealed with tape and a plastic sheet, or the structure may be covered with a tarp. The building will remain sealed for 2-72 hours depending on the specifics of the job. Warning signs are posted around the building notifying people to keep out.

After the fumigation period is completed, a professional fumigator will aerate the structure using fans for a prescribed aeration period. Once the dwelling has been thoroughly aerated, the fumigator is required to measure the level of any fumigant remaining in the living space to ensure it is below EPA approved concentration for reentry by the occupants.

Extremely low levels of fumigant can remain for a short period of time in dead air spaces between walls and inside cabinets as well as porous materials such as furniture. The small amount of fumigant in these areas will continue to dissipate for a few hours after the fumigation but at levels well below the established safe reentry concentration. Your building will not be cleared for re-occupancy until it is safe to enter. The fumigator will post a notice on your building indicating the day and time for reentry. Structures can be occupied only when the concentration is 1 part per million or less (this represents a margin of safety-laboratory animals have been exposed to 100 parts per million for 2 weeks with no adverse effects). Because Vikane is a true gas and not a vapor, aeration is rapid. Recent studies demonstrated that in most structures levels are less than 1 part per million after the prescribed aeration period and have no detectable levels of Vikane within 24 hours after the start of aeration.

Sulfuryl fluoride is a colorless, odorless gas, so a warning agent is added to the building that causes watery eyes and a scratchy throat. If you experience these symptoms in a structure that has been recently fumigated, you should leave immediately and call the pest control company to have your building retested.

Sulfuryl Fluoride

(Potential Health Risks From Overexposure)

Sulfuryl fluoride is a gas that can potentially enter your body only through inhalation. Because it is a gas, it does not stay on dry surfaces; therefore, there is no exposure from touching treated surfaces.

Specimen Label

RESTRICTED USE PESTICIDE DUE TO INHALATION TOXICITY

For sale to and use only by Certified Applicators or persons under their direct supervision and only for those uses covered by the Certified Applicator's certification.



SPECIALTY GAS FUMIGANT

®Trademark of Douglas Products and Packaging Company ("Douglas")

For control of: Existing infestations of listed insects and related pests such as drywood termites, Formosan termites, powder post beetles, death watch beetles, old house borers, bedbugs, cockroaches, clothes moths, rodents (rats, mice), and the larvae and adults of carpet beetles (except egg stage), oriental, American, and brown-banded cockroaches.

For use in: Dwellings (including mobile homes), buildings, construction materials, furnishings (household effects), shipping containers and vehicles including automobiles, buses, surface ships, passenger railcars, and recreational vehicles (but not including aircraft).

When fumigating, observe local, state, and federal rules and regulations including such things as use of chloropicrin, clearing devices, positive-pressure self-contained breathing apparatus, security requirements, and placement of warning signs.

Application personnel must participate in Douglas Products' Sulfuryl Fluoride Training and Stewardship Plan.

| | |
|------------------------|--------|
| Active Ingredient | |
| sulfuryl fluoride..... | 99.8% |
| Other Ingredients..... | 0.2% |
| Total | 100.0% |

EPA Reg. No. 1015-78

Keep Out of Reach of Children

DANGER  **POISON**

PELIGRO

Precaucion al usuario: Si usted no lee inglés, no use este producto hasta que la etiqueta le haya sido explicada ampliamente.

Precautionary Statements

Hazards to Humans and Domestic Animals

Extremely Hazardous Liquid And Vapor Under Pressure • Fatal If Inhaled • May Be Fatal If Swallowed • Liquid May Cause Freeze Burns of Exposed Skin

Do not get in eyes, on skin, or on clothing. Vikane® specialty gas fumigant is odorless. Exposure to toxic levels may occur without warning or detection by the user.

First Aid

In all cases of overexposure, such as nausea, difficulty in breathing, abdominal pain, slowing of movements and speech, numbness in extremities, get medical attention immediately. Take person to a doctor or emergency treatment facility.

If inhaled: Get exposed person to fresh air. Keep warm and at rest. Make sure person can breathe freely. If breathing has stopped, give artificial respiration. Do not put anything in the mouth of an unconscious person. Call a poison control center or doctor for further treatment advice.

If liquid is on skin or on clothing: Immediately apply water to contaminated area of clothing before removing. Once area has thawed, remove contaminated clothing, shoes, and other items covering skin. Wash contaminated skin area thoroughly or shower. Call a poison control center or doctor for further treatment advice.

If liquid is in eyes: Hold eye open and rinse slowly and gently with water for 15-20 minutes. Remove contact lenses, if present, after the first 5 minutes, then continue rinsing eye. Call a poison control center or doctor for treatment advice.

Note to Physician: Vikane is a gas which has no warning properties such as odor or eye irritation. (However, chloropicrin is used as a warning agent and is a known lachrymator). Early symptoms of exposure to Vikane are respiratory irritation and central nervous system depression. Excitation may follow. Slowed movement, reduced awareness, and slow or garbled speech may be noted. Prolonged exposure can produce lung irritation, pulmonary edema, nausea, and abdominal pain. Repeated exposure to high concentrations can result in significant lung and kidney damage. Single exposures at high concentrations have resulted in death. Treat symptomatically.

Liquid Vikane in the eye may cause damage due to refrigeration or freezing.

Refer to elsewhere on this label for additional precautionary information and Directions for Use.

Notice: Read the entire label. Use only according to label directions. Before using this product, read Warranty Disclaimer, Inherent Risks of Use, and Limitation of Remedies elsewhere on this label. If terms are unacceptable, return at once unopened.

In case of emergency endangering health or the environment involving this product, call 1-844-845-3129 or 1-352-323-3500.

Agricultural Chemical: Do not ship or store with food, feeds, drugs or clothing.

Directions for Use

It is a violation of Federal law to use this product in a manner inconsistent with its labeling.

Read all Directions for Use carefully before applying.

Storage and Handling

Store in dry, cool, well ventilated area under lock and key. Post as a pesticide storage area. If the storage area is in an occupied building, the storage area must have either 1) a forced air ventilation system that meets required local ordinances for the storage of hazardous materials and operates continuously; or 2) be equipped with a permanently mounted and properly maintained and functioning sulfuryl fluoride monitoring device designed to alert occupants of the building if sulfuryl fluoride in the air of the storage area is greater than 1 ppm. Store cylinders upright, secured to a rack or wall to prevent tipping. Do not contaminate water, food, or feed by storage.

Cylinders must not be subjected to rough handling or mechanical shock such as dropping, bumping, dragging, or sliding beyond that which would normally occur when moving cylinders. Do not transport any cylinders in closed vehicles where they occupy the same common airspace as personnel. Transport securely only in an upright position.

Do not remove valve protection bonnet and safety cap until immediately before use. Replace safety cap and valve protection bonnet when cylinder is not in use.

When cylinder is empty, close valve, screw safety cap onto valve outlet, and replace protection bonnet before returning to supplier. Only the registrant is authorized to refill cylinders. Do not use cylinder for any other purpose. Follow registrant's instructions for return of empty or partially empty cylinders.

Leak Procedures: Evacuate immediate area of leak. Use a NIOSH or MSHA approved positive pressure self-contained breathing apparatus (SCBA, not SCUBA) or combination air-supplied/SCBA respirator, such as manufactured by Ranger, Survivair, Scott, or MSA, for entry into affected areas to correct problem. Move leaking or damaged cylinder outdoors or to an isolated location, observing strict safety precautions. Work upwind if possible. Do not permit entry into leakage area by

Specimen Label



Chloropicrin

Warning Agent

For Non-Pesticidal Use Only

For Use only by applicators certified to apply Vikane® gas fumigant or persons under their direct supervision.

NOTE: Chloropicrin Warning Agent is a highly hazardous material and must be handled only by individuals trained in its proper use. Consult Dow AgroSciences for correct procedure before using.

| | |
|-------------------------|--------|
| Active Ingredients: | |
| Chloropicrin | 96.0% |
| Inert Ingredients | 4.0% |
| Total | 100.0% |

Contains 13.7 pounds of chloropicrin per gallon.

Keep Out of Reach of Children

**DANGER
PELIGRO**



POISON

Si usted no entiende la etiqueta, busque a alguien para que se la explique a usted en detalle. (If you do not understand the label, find someone to explain it to you in detail.)

IN ALL CASES OF OVEREXPOSURE, GET MEDICAL ATTENTION IMMEDIATELY BY TRANSPORTING TO AN EMERGENCY TREATMENT FACILITY.

First Aid

If inhaled: Remove to fresh air. If not breathing, give artificial respiration. If breathing is difficult, give oxygen. Get medical attention immediately.

If case of skin contact, immediately flush skin with plenty of water for at least 15 minutes while removing contaminated clothing or other items covering the skin and shoes. Get medical attention.

Air expose shoes or clothing outside and do not wear until free of all traces of contamination.

If case of eye contact, immediately flush eyes with plenty of water for at least 30 minutes. Get medical attention immediately.

If swallowed, do not induce vomiting. Give large amounts of water or milk; get medical attention immediately.

Note to Physician: Chloropicrin is a volatile liquid that is an active ingredient in tear gas. As a gas it is a powerful lacrymator. Symptoms of overexposure are profuse lacrymation, respiratory distress and vomiting. Pulmonary edema may develop later.

Notice: Read the entire label. Use only according to label directions. Before buying or using this product, read "Warranty Disclaimer" and "Limitation of Remedies" elsewhere on this label.

In case of emergency endangering health or the environment involving this product, call 1-800-992-5994. If you wish to obtain additional product information, visit our web site at www.dowagro.com (See Vikane)

Precautionary Statements

Hazards to Humans and Domestic Animals

DANGER

Causes Severe Burns Of Eye Or Skin. May Be Fatal If Absorbed Through The Skin. Causes Severe Burns of Mouth And Throat If Swallowed. May Be Fatal If Inhaled. May Cause Severe Allergic Respiratory Reaction. High Concentration Can Cause Lung Injury.

Do not get in eyes, on skin or on clothing. Avoid breathing gas/vapor. Do not take internally. Avoid prolonged or repeated respiratory contact. Use only with adequate ventilation. Wash thoroughly after handling.

Personal Protective Equipment

The following Personal Protective Equipment must be worn when handling and dispensing chloropicrin:

- Chemical-resistant gloves (such as neoprene)
- Full face shield or chemical goggles
- Respiratory Protection: When air concentrations exceed a level of 0.1 ppm, wear NIOSH approved positive pressure supplied-air respirator for organic vapors.

Chemical Hazard

Chloropicrin is severely corrosive of metal containers made of magnesium, aluminum, or their alloys.

Storage and Handling

Storage: Store upright in a cool, dry, well-ventilated area under lock and key. Store only in original container. Do not contaminate water, food or feed by storage or disposal.

Spill and Leak Procedures: Evacuate immediate area of spill or leak. Use a self-contained breathing apparatus (SCBA) for entry into affected area to correct the problem. Move the leaking or damaged containers outdoors or to an isolated location, observing strict safety precautions. Work upwind if possible. Allow spilled material to evaporate, or absorb onto vermiculite, dry sand, earth, or similar absorbent material.

Thoroughly aerate absorbent materials outdoors prior to disposing on site or at an approved disposal facility. Do not permit entry into spill area or cleanup area by unprotected persons until the concentration of chloropicrin is determined to be less than 0.1 ppm, by testing with an approved detection device.

Disposal: Allow empty container to aerate with cap off within secure area, such as within the structure during fumigation. Replace cap. Dispose of in a sanitary landfill or by other approved state and local procedures.

GRAPH SHEET

OWNER'S NAME _____

DATE 6/11/21

ADDRESS 1915 Alston
HOUSTON, TX 77008

END-O-PEST
COASTAL FUMIGATORS
1119 West 34th Street
Houston, TX 77018

Phone: (713) 863-7378
TDA TPCL # 0567998
TDA TPCL # 0568806

HOME PH. _____
WORK PH. _____
CELL PH. _____

XTIME
SERVICE ADDRESS

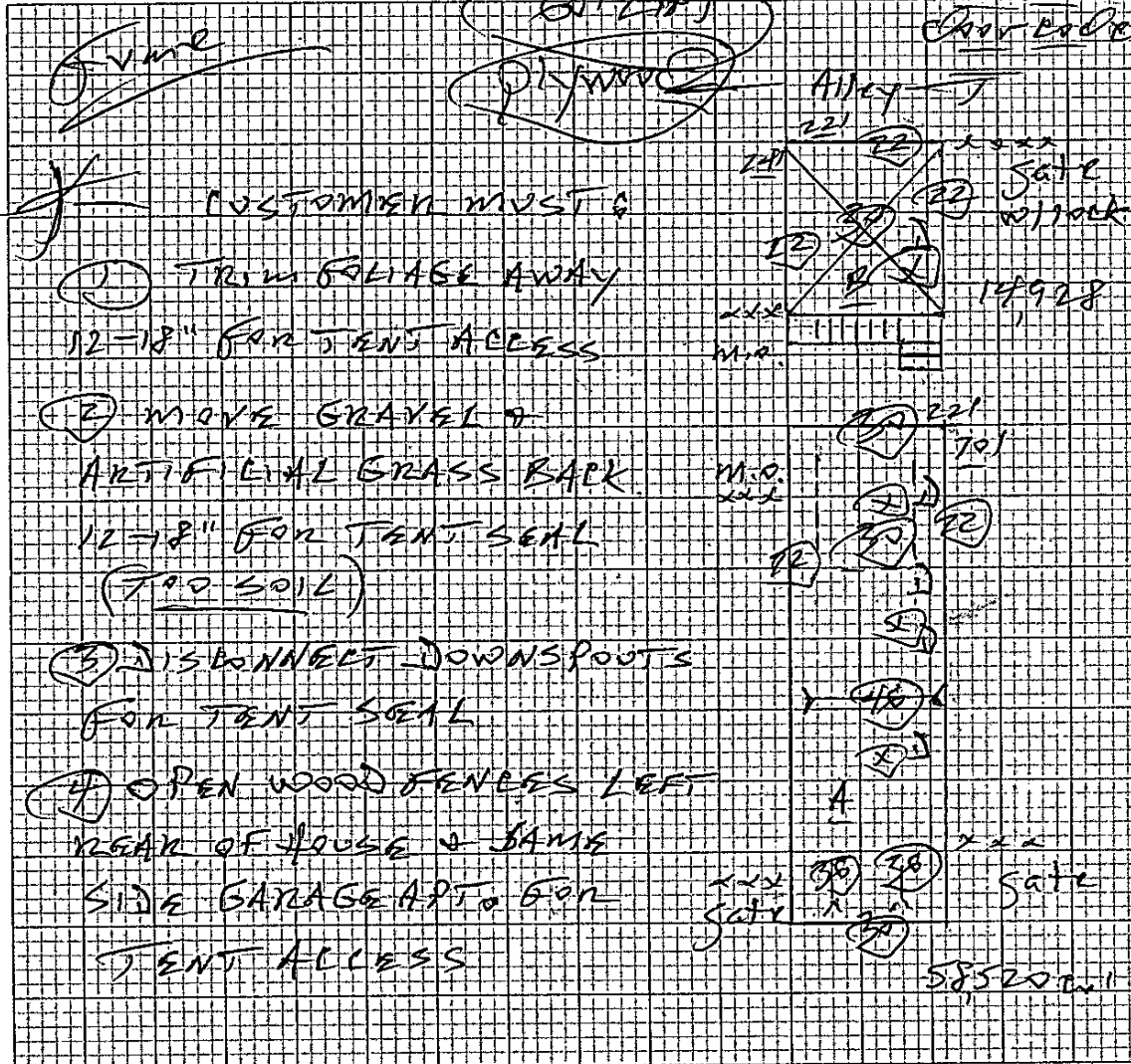

"S" Subterranean Termites

"D" Drywood Termites

"P" Wood Boring Beetles

Damage

USE

- residential occupied
- commercial vacant
- apartment

FOUNDATION

- slab
- pier & beam
- other

EXTERIOR

- brick
- wood
- other Handi

ROOF

- wood shingle
- composition
- other

TERMITICIDE Vikane % 99.8 GALLONS NA

TYPE OF TREATMENT IS: SPOT ; PARTIAL ; FULL

OBSTRUCTIONS OR INACCESSIBLE AREAS INCLUDE BUT ARE NOT LIMITED TO THE FOLLOWING:

- Bath trap, drain area
- shower drain
- other
- Ivy or vines
- decking
- soil over siding
- expansion joint
- wood pile
- soil over slab

CONDITIONS CONDUCTIVE TO WOOD DESTROYING INSECTS INCLUDE BUT ARE NOT LIMITED TO THE FOLLOWING:

- above ground moisture
- leak in roof
- decay in roof
- wood pile next to structure
- decaying expansion joint
- other
- standing water
- soil over siding
- soil over slab
- decay in threshold
- wet rot in siding
- decay in eaves
- Ivy or vines
- decay around window(s)
- decay in door jamb
- wood to ground contact

[Signature]

CA# 0558894

COMPANY REPRESENTATIVE

CUSTOMER

OWNER'S NAME

GRAPH SHEET

DATE 6/11/21

ADDRESS 1015 Alston Houston, TX 77008

END-O-PEST COASTAL FUMIGATORS 1119 West 34th Street Houston, TX 77018

Phone: (713) 863-7378 TDA TPCL # 0567998 TDA TPCL # 0568806

HOME PH.

WORK PH.

CELL PH.

XTIME
601 CTS
plywood

Knob Jack
door code?

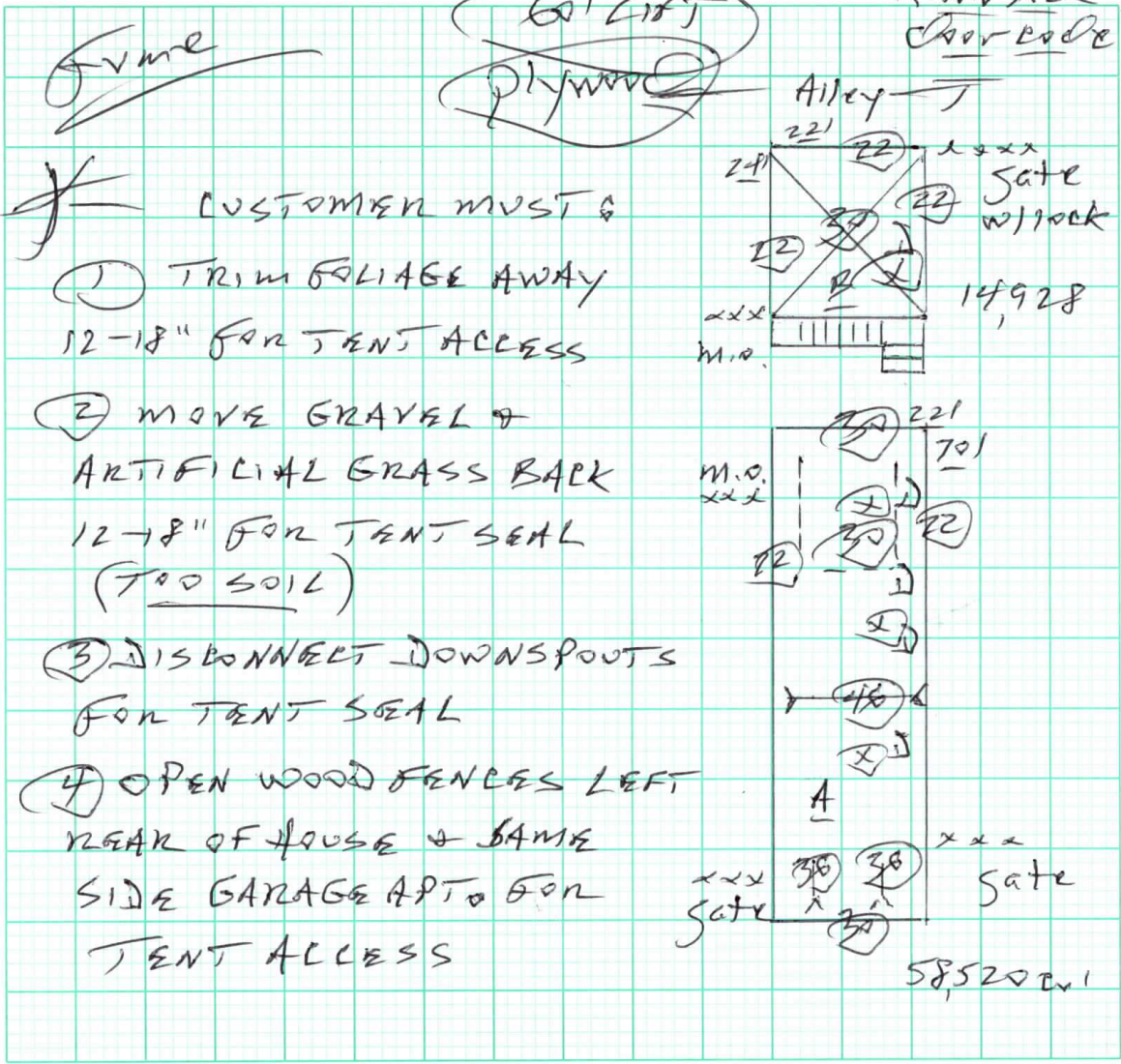

- * CUSTOMER MUST
- 1) TRIM FOLIAGE AWAY 12-18" FOR TENT ACCESS
- 2) MOVE GRAVEL & ARTIFICIAL GRASS BACK 12-18" FOR TENT SEAL (TOP SOIL)
- 3) DISCONNECT DOWNSPOUTS FOR TENT SEAL
- 4) OPEN WOOD FENCES LEFT REAR OF HOUSE & SAME SIDE GARAGE APT FOR TENT ACCESS

"S" Subterranean Termites "D" Drywood Termites "P" Wood Boring Beetles Damage

USE FOUNDATION EXTERIOR ROOF

residential occupied slab brick wood shingle

commercial vacant pier & beam wood composition

apartment other other other other

TERMITICIDE Vikane % 99.8 GALLONS NA

TYPE OF TREATMENT IS: SPOT PARTIAL FULL

OBSTRUCTIONS OR INACCESSIBLE AREAS INCLUDE BUT ARE NOT LIMITED TO THE FOLLOWING:

Bath trap, drain area Ivy or vines soil over siding wood pile

shower drain decking expansion joint soil over slab

other

CONDITIONS CONDUCIVE TO WOOD DESTROYING INSECTS INCLUDE BUT ARE NOT LIMITED TO THE FOLLOWING:

above ground moisture standing water decay in eaves

leak in roof soil over siding Ivy or vines

decay in roof soil over slab decay around window(s)

wood pile next to structure decay in threshold decay in door jamb

decaying expansion joint wet rot in siding wood to ground contact

other

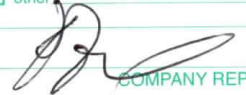
 CA# 0558894 CUSTOMER