

NOTE: THIS PROPERTY IS NOT IN THE 100 YEAR FLOOD ZONE, IS IN ZONE-C, PER F.I.R.M. MAP# 480296-0150D DATED 9/27/85.

MURRAY BROOK DRIVE
60' R.O.W.

PLAT OF

LOT 8 BLOCK 2 OF BRAEBURN VALLEY, SECTION THREE (3)

ACCORDING TO THE PLAT RECORDED IN VOL 61 PAGE 47 OF THE

MAP **RECORDS OF HARRIS COUNTY, TEXAS**
KNOWN AS 10007 MURRAY BROOK DRIVE LENDER CITYFED MORTGAGE SERVICES
PROPERTY OF MARTIN WILLIAM BACHOP

I hereby certify that this survey was made on the ground and that this plat correctly represents the facts found at the time of survey showing the improvements.

There are no encroachments apparent on the ground, except as shown.

This survey was performed in connection with the transaction described in
 GP #49-121977 of FIRST AMERICAN TITLE CO.

Fred W. Lawton, Registered Public Surveyor No. 2321

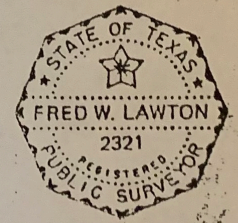

DATE 6-11-86
 SCALE 1"=20'-0"
 JOB NO 3100-86

SOUTH TEXAS SURVEYING ASSOCIATES, INC.
 11281 RICHMOND #J-101 HOUSTON, TEXAS 77082
 713 556-6918