

**INVOICE**

**FROM:**  
 David Linn  
 Linn Appraisals LLC  
 1082 Forest Haven Ct  
 Conroe, TX 77384

Telephone Number: (281) 389-7513      Fax Number:

INVOICE NUMBER	
240428	
DATES	
Invoice Date:	05/01/2024
Due Date:	
REFERENCE	
Internal Order #:	240428
Lender Case #:	
Client File #:	
FHA/VA Case #:	
Main File # on form:	240428
Other File # on form:	
Federal Tax ID:	
Employer ID:	

**TO:**  
 Gamal Mouallem

E-Mail:  
 Telephone Number:      Fax Number:  
 Alternate Number:

**DESCRIPTION**

Lender:      Client: Gamal Mouallem  
 Purchaser/Borrower:  
 Property Address: 6 W Rumplescreek Pl  
 City: Spring  
 County: Montgomery      State: TX      Zip: 77381  
 Legal Description: Lot 31, Block 3, The Woodlands Village of Cochrans Crossing, Section 31

**FEES****AMOUNT**

Measuring Fee	200.00
<b>SUBTOTAL</b>	
	200.00

**PAYMENTS****AMOUNT**

Check #:	Date:	Description:	
Check #:	Date:	Description:	
Check #:	Date:	Description:	
<b>SUBTOTAL</b>			0.00
Paid in Full			<b>TOTAL DUE</b> \$ 200.00

## Building Sketch

<b>Borrower</b>					
Property Address	6 W Rumplecreek Pl				
City	Spring	County	Montgomery	State	TX
				Zip Code	77381
Lender/Client					

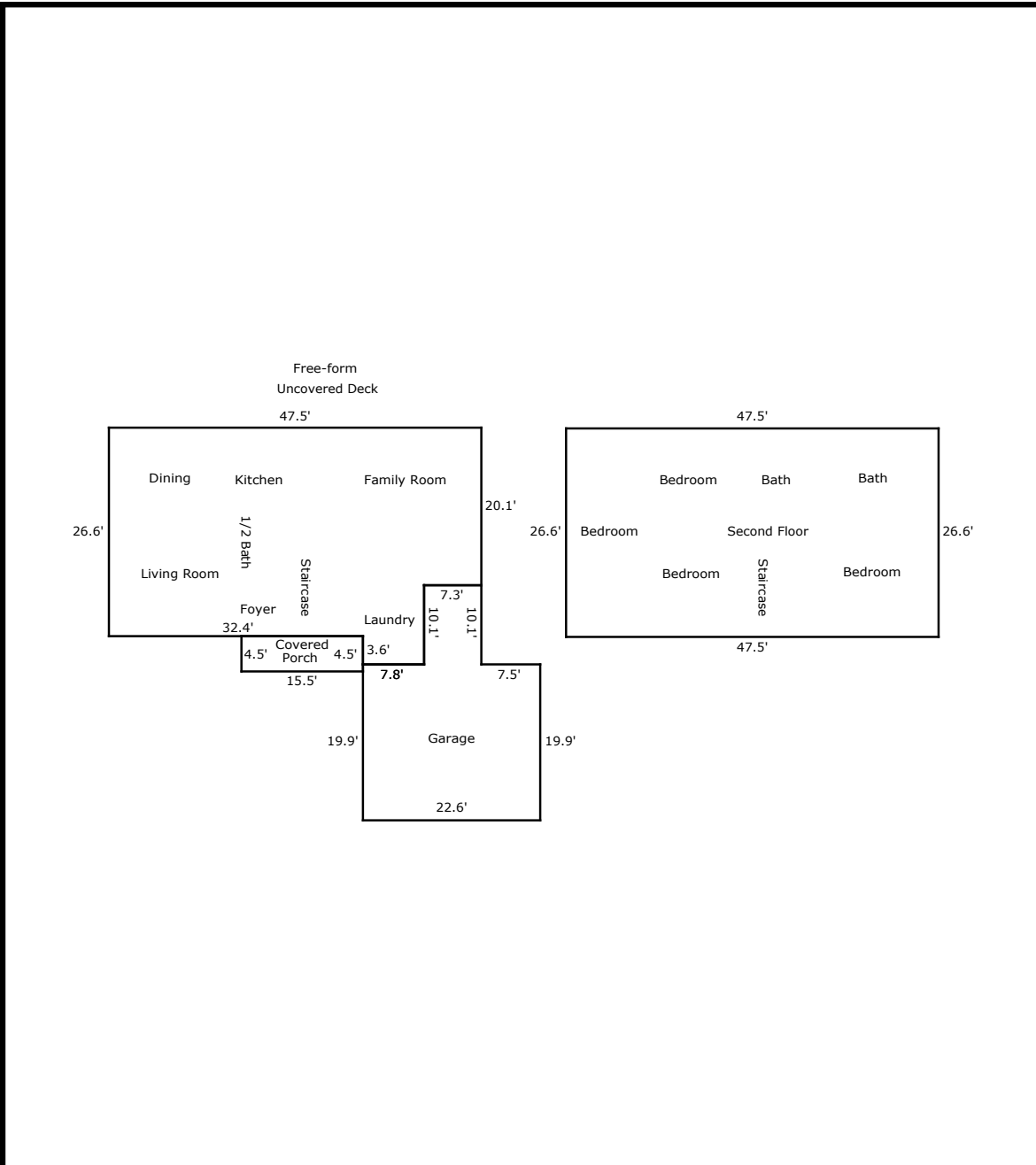

TOTAL Sketch by a la mode

### Area Calculations Summary

Living Area	Calculation Details	
First Floor	1244.1 Sq ft	$26.6 \times 32.4 = 861.8$ $7.8 \times 10.1 = 78.8$ $20.1 \times 15.1 = 303.5$
Second Floor	1263.5 Sq ft	$47.5 \times 26.6 = 1263.5$
<b>Total Living Area (Rounded):</b>	<b>2508 Sq ft</b>	
<b>Non-living Area</b>		
2 Car Garage	523.5 Sq ft	$22.6 \times 19.9 = 449.7$ $10.1 \times 7.3 = 73.7$
Covered Porch	69.8 Sq ft	$4.5 \times 15.5 = 69.8$

# Appraiser Certification



## Certified Residential Real Estate Appraiser

Appraiser: **David William Linn**

License #: **TX 1360349 R**

License Expires: **10/31/2024**

Having provided satisfactory evidence of the qualifications required by the Texas Appraiser Licensing and Certification Act, Occupations Code, Chapter 1103, authorization is granted to use this title:  
Certified Residential Real Estate Appraiser

For additional information or to file a complaint please contact TALCB at [www.talcb.texas.gov](http://www.talcb.texas.gov).

  
Chelsea Buchholtz  
Commissioner