

**Building Sketch (Page - 1)**

Borrower					
Property Address	16421 Westbury Rd				
City	Beaumont	County		State	TX Zip Code 77713
Lender/Client	Jerry Zimmerman				

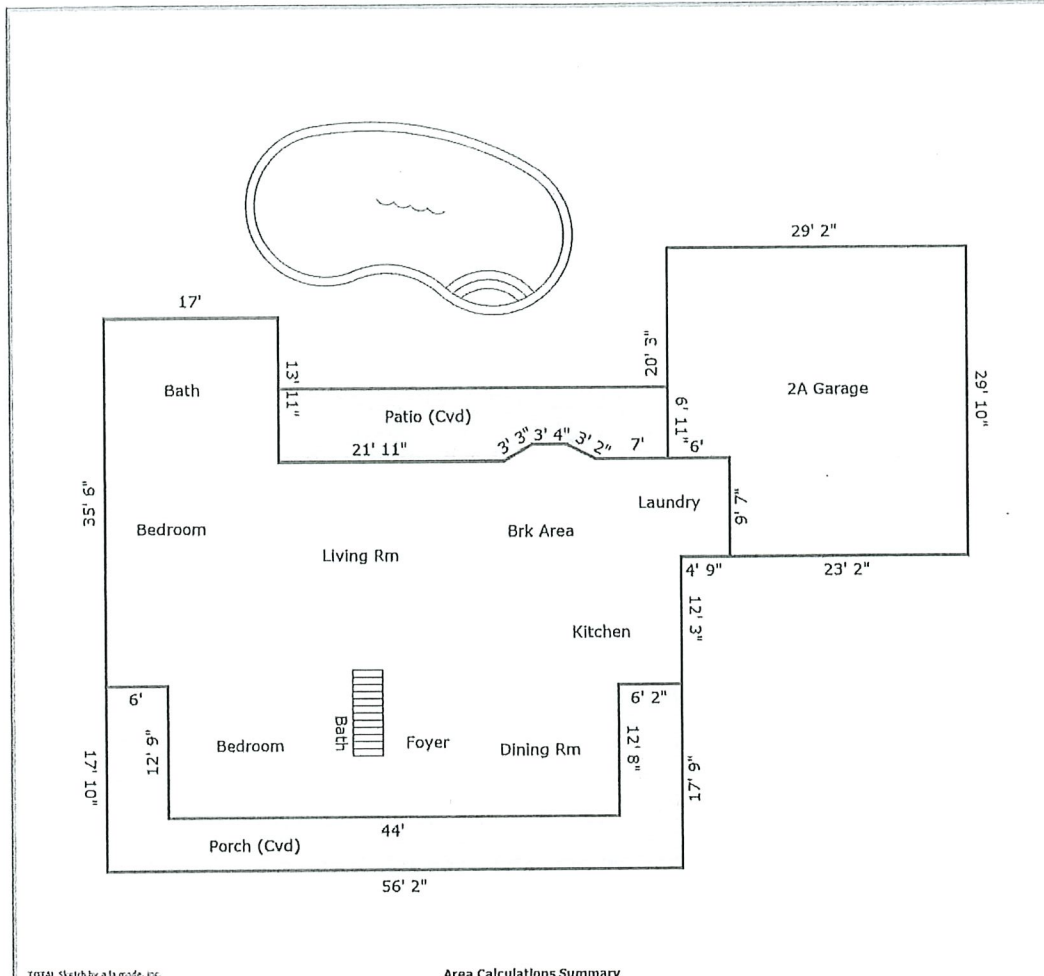

TOTAL Sketch by a la mode, inc.

**Area Calculations Summary**

		Calculation Details
Living Area	2067.51 Sq ft	17 x 13.92 = 236.58
First Floor		0.5 x 2.53 x 1.46 = 1.84
		0.5 x 1.46 x 2.85 = 2.08
		3.33 x 1.46 = 4.86
		0.5 x 0.29 x 0.17 = 0.02
		21.71 x 0.17 = 3.62
		60.92 x 9.42 = 573.63
		56.17 x 12.17 = 683.36
		50.17 x 0.08 = 4.18
		44 x 12.67 = 557.33
<b>Total Living Area (Rounded):</b>	<b>2068 Sq ft</b>	
Non-living Area	440.12 Sq ft	6 x 12.75 = 76.5
Cvd Porch		6.17 x 12.67 = 78.11
		56.17 x 5.08 = 285.51
2 Car Attached	812.64 Sq ft	29.83 x 23.17 = 691.14
		6 x 20.25 = 121.5
Covered Patlo	257.15 Sq ft	6.92 x 7 = 48.42
		7.08 x 21.92 = 155.24
		9 x 5.46 = 49.12
		0.5 x 2.81 x 1.62 = 2.29
		0.5 x 2.85 x 1.46 = 2.08

3433 A

### Building Sketch (Page - 2)

<b>Borrower</b>				
Property Address	16421 Westbury Rd			
City	Beaumont	County	State	TX Zip Code 77713
Lender/Client	Jerry Zimmerman			

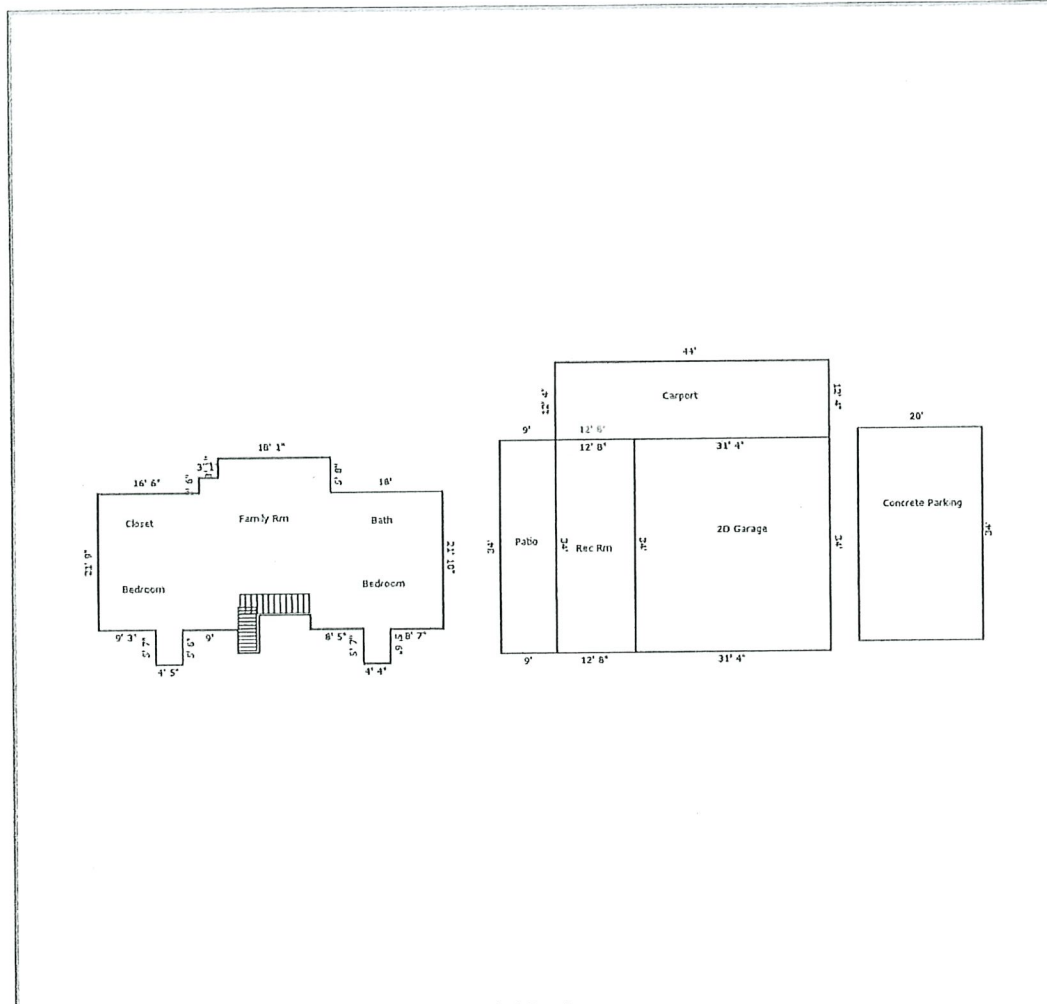

TOTAL Sketch by a la mode, Inc.

#### Area Calculations Summary

		Calculation Details	
<b>Living Area</b>			
Second Floor	1364.77 Sq ft	21.83 x 8.58 =	187.4
		21.75 x 9.25 =	201.19
		27.33 x 4.42 =	120.72
		21.83 x 2.83 =	61.86
		24.33 x 3.08 =	75.03
		27.42 x 3.08 =	84.53
		31.08 x 3.5 =	108.79
		25.08 x 8.17 =	204.85
		27.42 x 3.33 =	91.39
		21.75 x 5.08 =	110.56
		27.33 x 4.33 =	118.44
<b>Total Living Area (Rounded):</b>	<b>1365 Sq ft</b>		
<b>Non-living Area</b>			
Rec Room	430.67 Sq ft	34 x 12.67 =	430.67
1 Car Carport	542.67 Sq ft	44 x 12.33 =	542.67
Concrete Patio	306 Sq ft	34 x 9 =	306
2 Car Detached	1065.33 Sq ft	31.33 x 34 =	1065.33
Parking	680 Sq ft	34 x 20 =	680