

Scale: 1" = 20'

**4005 Alford Street  
Mendy Haney**

Being all of Lot 17 (SEVENTEEN), Block 2 (TWO), BRIDGEWOOD SUBDIVISION, PHASE 2, an addition to the City of College Station, Brazos County, Texas, according to the plat recorded in Volume 12756 Page 292 of the Official Records of Brazos County, Texas.

I, Paul Williams, Registered Professional Land Surveyor No. 5743 do hereby certify that this plat represents the results of a survey performed on the ground, under my supervision on September 7, 2017, and is true and correct to the best of my knowledge.

I further certify that no improvements on this property encroach on adjacent property, nor do any improvements on adjacent property encroach on to this property, except as shown.

Notes:  
North orientation is based on rotating to plat calls in 12756/292.

This survey was prepared with the benefit of Aggieldand Title Company Commitment No. G.F. 36672 and is valid for this transaction only.

The Following Easements appear to effect the parent tract of this property, however no above ground evidence was located on this survey:

- From Wayne A. Dunlap, et al to Producers Gas Company in 534/88; partially released in 11138/38. Blanket Easements:
  - 1) From W. S. Barron, et al to Sinclair Refining Company in 132/123.
  - 2) From Wayne A. Dunlap, et al to Wellborn Water Supply Corporation in 303/296.
  - 3) From Wayne A. Dunlap, et al to The City of Bryan in 350/130; and in 479/267.
  - 4) From Wayne A. Dunlap, et al to Williams Communications, Inc. in 3261/334; and in 3621/341; and in 3621/345; and in 3622/1.
- p:/pwlsc/clients/2017/sc17088.dwg

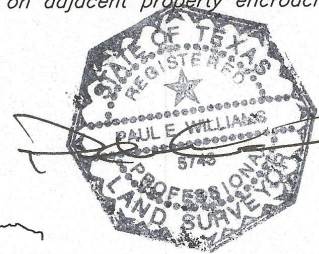

**PAUL WILLIAMS**  
LAND SURVEYING CO.  
R.P.L.S. No. 5743  
Firm No. 10014300

1851 Briarcrest  
Bryan, TX 77802  
979-779-7670  
Fax 979-779-7672  
pwlansurveying@earthlink.net