

- LEGEND**
- 1/2" IRON ROD FOUND (RPLS 3538)
 - H.C.C.F. - HARRIS COUNTY CLERK FILE
 - H.C.M.R. - HARRIS COUNTY MAP RECORD
 - H.C.D.R. - HARRIS COUNTY DEED RECORD
 - COVD - COVERED
 - CONC - CONCRETE
 - (TYP) - TYPICAL EXAMPLE
 - W/ - WITH
 - OH - OVERHEAD
 - P.I. - POINT OF INTERSECTING TANGENTS
 - R.O.W. - RIGHT OF WAY
 - P.I. - SYMBOL
 - - SURVEY MONUMENT
 - OH— - OH ELECTRIC
 - E—E— - POWER POLE
 - - STORM MANHOLE
 - - WATER METER
 - - WATER WELL

FLOOD INFORMATION

*BASED ON VISUAL EXAMINATION, THIS TRACT LIES WITHIN ZONE "X" DEFINED AS "AREAS DETERMINED TO BE OUTSIDE THE 0.2% ANNUAL CHANCE FLOODPLAIN", AND ZONE "A" DEFINED AS A SPECIAL FLOOD HAZARD AREA WITHOUT BASE FLOOD ELEVATION, PER F.E.M.A. FLOOD INSURANCE RATE MAP PANEL NO: 48015C0225F REVISION DATE: OCTOBER 19, 2019. *INACCURACIES OF F.E.M.A. MAPS PREVENT EXACT DETERMINATION WITHOUT DETAILED FIELD STUDIES.

NOTES

- 1) ALL BEARINGS SHOWN ARE REFERENCED TO THE TEXAS STATE PLANE COORDINATE SYSTEM, SOUTH CENTRAL ZONE (4204) NAD 83 PER FOUND MONUMENTS & GPS OBSERVATIONS.
- 2) THIS SURVEY WAS PREPARED WITH A TITLE COMMITMENT ISSUED BY OLD REPUBLIC NATIONAL TITLE INSURANCE COMPANY UNDER G.F. NO. 231305005Y WITH AN EFFECTIVE DATE OF OCTOBER 6, 2023.
- 3) PROPERTY IS SUBJECT TO RESTRICTIVE COVENANTS AS RECORDED IN VOLUME 2, PAGE 17 OF THE MAP AND/OR PLAT RECORDS, COUNTY CLERK'S FILE NO(S), 071312, 076016, 134528, 161555 AND 213182, OF THE OFFICIAL PUBLIC RECORDS OF AUSTIN COUNTY, TEXAS.

LAND TITLE SURVEY OF LOT 5 IN BLOCK NO. 5, GINDORF ESTATES, BEING SITUATED IN THE JAMES CUMMING HACIENDA MIDDLE 2 LEAGUE, A-31, AND AS SHOWN ON PLAT OF GINDORF ESTATES SUBDIVISION, VOLUME 2, PAGE 17 AND 18, OFFICIAL RECORDS OF AUSTIN COUNTY, TEXAS.

I HEREBY CERTIFY THAT THIS SURVEY WAS MADE ON THE GROUND UNDER MY SUPERVISION AND THAT IT CORRECTLY REPRESENTS THE FACTS FOUND AT THE TIME OF THE SURVEY.

MONUMENT SURVEYS, LLC
 TEXAS FIRM NO. 10194694

14511 OLD KATY ROAD
 SUITE 230
 HOUSTON TX, 77079

OFC : 713-913-3150
 DIR : 713-562-8570
 EMAIL : ALAN@MONUMENT-SURVEYS.COM
 CONTRACTED TO RRR SURVEYING
 RPLS NO. 5883

WWW.MONUMENT-SURVEYS.COM

COPYRIGHT 2023, MONUMENT SURVEYS, LLC

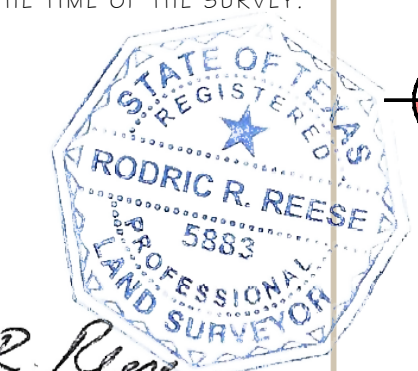

Rodric R. Reese
 RODRIC R. REESE
 REGISTERED PROFESSIONAL LAND SURVEYOR
 TEXAS REGISTRATION NO. 5883

JOB NO.	2000-2000
JOB ADDRESS	0 EMERALD DRIVE BELLVILLE, TEXAS 77416
CLIENT	WILLIAM A LYONS
DATE ISSUED	OCTOBER 19, 2023
DRAWN BY	T.L.M.