

1-HOUR FIRE RATED OVERHANG AT PORCH PER FIRE RATED SOFFIT DETAIL

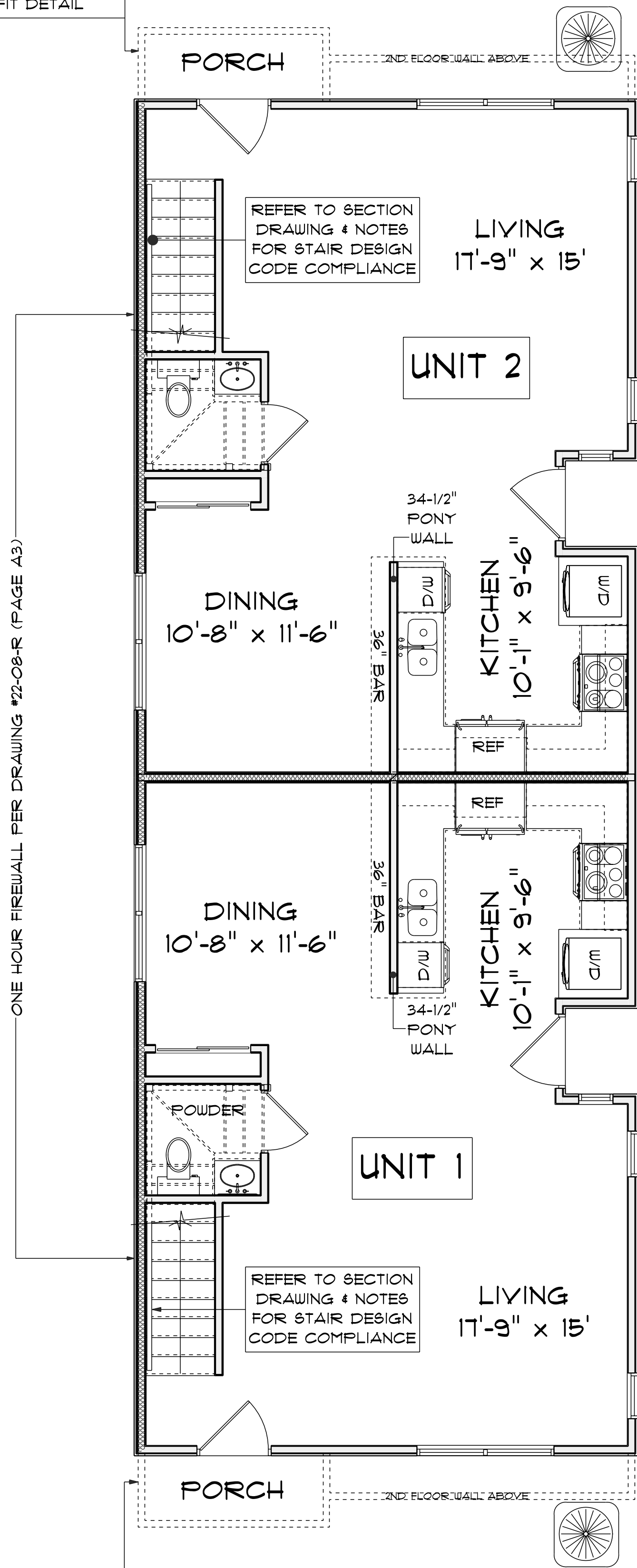

ONE HOUR FIREWALL PER DRAWING #22-08-R (PAGE A3)

1-HOUR FIRE RATED OVERHANG AT PORCH PER FIRE RATED SOFFIT DETAIL

FIRST FLOOR
 1/8" = 1'-0" (11x17)
 1/4" = 1'-0" (22x34)

AREA SCHEDULE
UNIT 1
 1st Floor Living: 630 SF
 2nd Floor A/C: 698 SF
 Total Living: 1,328 SF
 Covered Porch: 31 SF
 Total Covered: 1,359 SF

UNIT 2
 1st Floor Living: 630 SF
 2nd Floor A/C: 698 SF
 Total Living: 1,328 SF
 Covered Porch: 31 SF
 Total Covered: 1,359 SF

TOTAL BBUILDING
 1st Floor Living: 1,260 SF
 2nd Floor A/C: 1,396 SF
 Total Living: 2,656 SF
 Covered Porch: 62 SF
 Total Covered: 2,718 SF

ALL 2ND FLOOR WINDOWS TO HAVE 1'-0" HEADER & BOTTOM OF WINDOW TO BE A MINIMUM OF 24" ABOVE FINISHED FLOOR

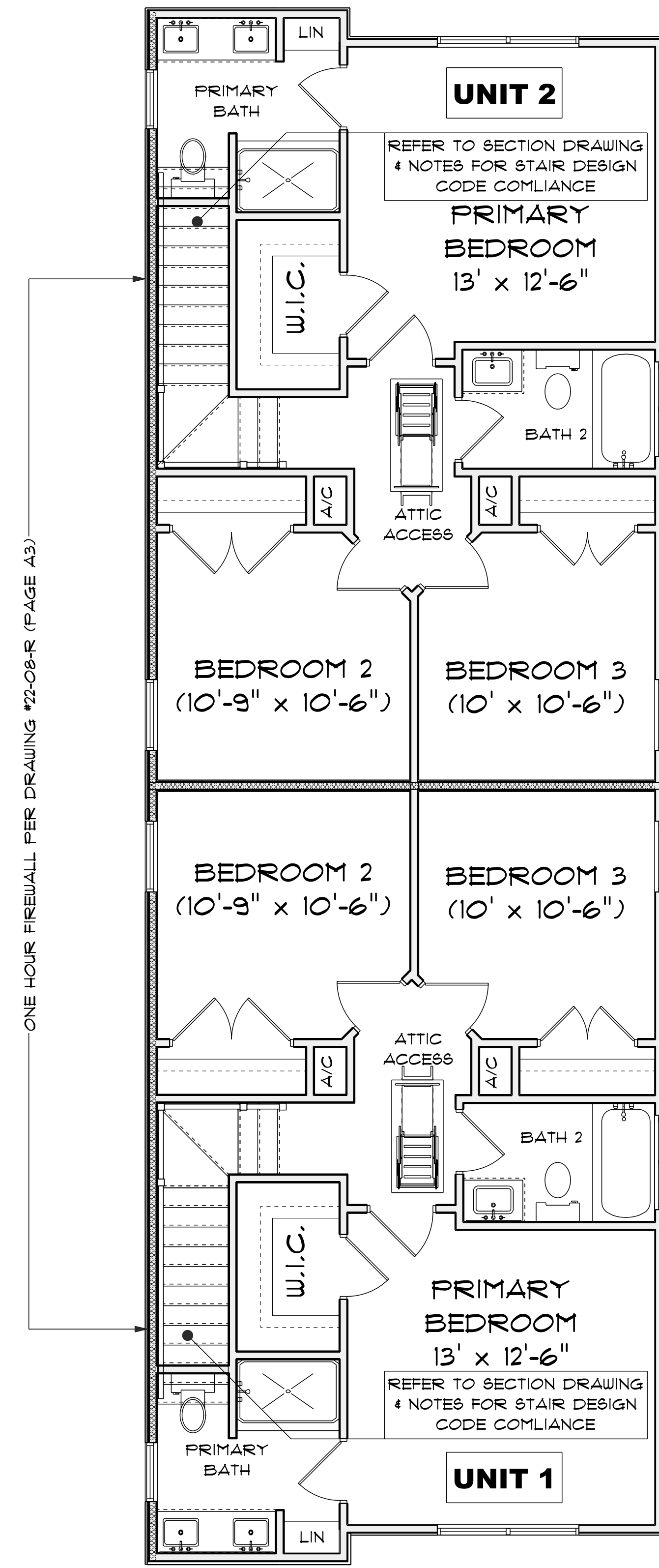

ONE HOUR FIREWALL PER DRAWING #22-08-R (PAGE A3)

SECOND FLOOR
 1/8" = 1'-0" (11x17)
 1/4" = 1'-0" (22x34)

DATE:

REV:

978
 MARJORIE
 STREET

Drawn By: Kevin G

PROPERTY OF:
 K-TEX Services, LLC

THE DESIGNER ASSUMES NO LIABILITY FOR ERRORS OR OMISSIONS ON THESE PLANS. ALL INFORMATION MUST BE CONFIRMED PRIOR TO BEGINNING CONSTRUCTION. THESE DRAWINGS HAVE BEEN DEVELOPED AND ISSUED WITHOUT KNOWLEDGE OF GEOGRAPHIC LOCATION. IT IS THE OWNER AND BUILDER'S RESPONSIBILITY FOR FOLLOWING MATERIAL AND MANUFACTURER'S INSTRUCTIONS, AND TO USE RECOGNIZED STANDARDS FOR EACH TRADE, AS WELL AS COMPLY IN FULL WITH ALL GOVERNING CODE REQUIREMENTS AND THE ENGINEER'S PLANS AND SPECIFICATIONS FOR THE GEOGRAPHIC AREA IN WHICH THIS HOME IS TO BE CONSTRUCTED.