

square footage

FIRST FLOOR	1,507	SQ.FT.
SECOND FLOOR	1,120	SQ.FT.
QUARTERS	600	SQ.FT.
PORCH	24	SQ.FT.
GARAGE	403	SQ.FT.
TOTAL COVD. AREA	3,654	SQ.FT.

first floor plan  
as-built

**Rice Residential Design, LLC**  
 HOUSTON, TX.  
 TEL. (713) 984-8604  
 www.riceresidentialdesign.com

A PROJECT FOR:  
**Joe Phan**  
 PROJECT LOCATION:  
 1610 Saint Helier St  
 lot 34 block 34 sect. III  
 subd. Country Club Estates

REVISIONS	DATE	DESCRIPTION

JOB NO: x  
 PLAN NO: x  
 SCALE: 1/4" = 1'-0"

SHEET NO:  
**1 OF 0**

24" x 36"

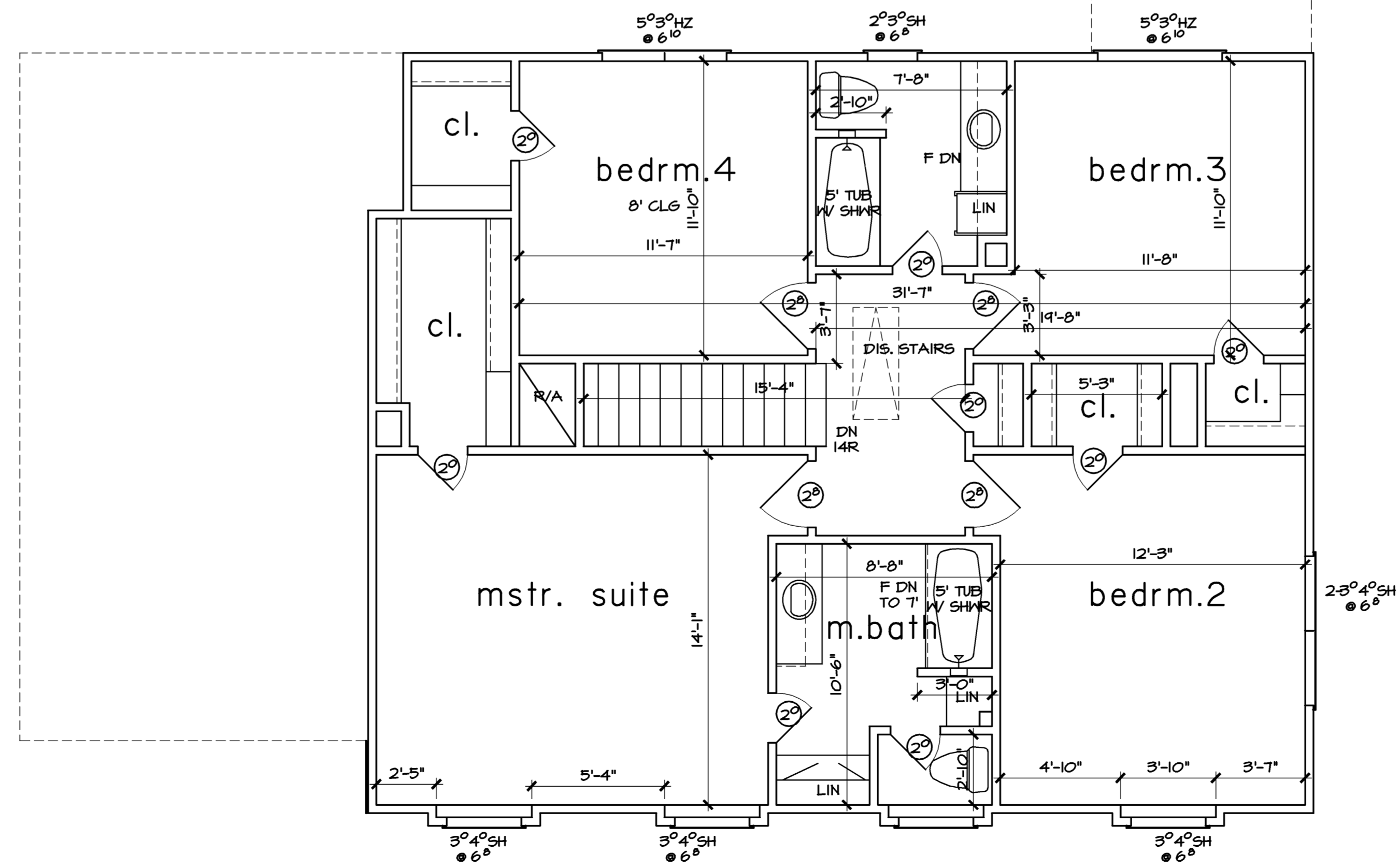

second floor plan  
as-built

N.C.B.A.C.  
 Rice Residential Design, LLC  
 HOUSTON, TX.  
 TEL. (713) 984-8604  
 www.riceresidentialdesign.com

TODD D RICE #540  
 DATE: \_\_\_\_\_

A PROJECT FOR:  
**Joe Phan**  
 PROJECT LOCATION:  
 16110 Saint Helier St  
 lot 34 block 34 sect. III  
 subd. Country Club Estates

REVISIONS	DATE	DESCRIPTION

JOB NO: x  
 PLAN NO. x  
 SCALE: 1/4" = 1'-0"

SHEET NO:  
**1 OF 0**