

14014 SUSAN COURT
(50' E.O.W.)

Restrictive covenants as set out in Volume 23, Page 30 and Volume 26, Page 9, Plat Records; Volume 979, Page 215 and Volume 1011, Page 339, Deed Records; Volume 2660, Page 2366, Official Records.
*Agreement for underground/overhead electric service with H.L. & P. as set out in Volume 943, Page 613, Deed Records.

BUYER: Glenn D. Williams and Heather H. Williams 14014 Susan Court Sugar Land, Texas 77478

DESCRIBED PROPERTY: Lot 90, in Block 5, of CORRECTED PLAT OF RAGUS LAKE ESTATES SECTION 1, a subdivision in Fort Bend County, Texas, according to the map or plat thereof recorded in Volume 26, Page 9 of the Plat Records of Fort Bend County, Texas.

TEXAS  SURVEYORS, INC.

G.F. 98-302580
DATE 10-26-98

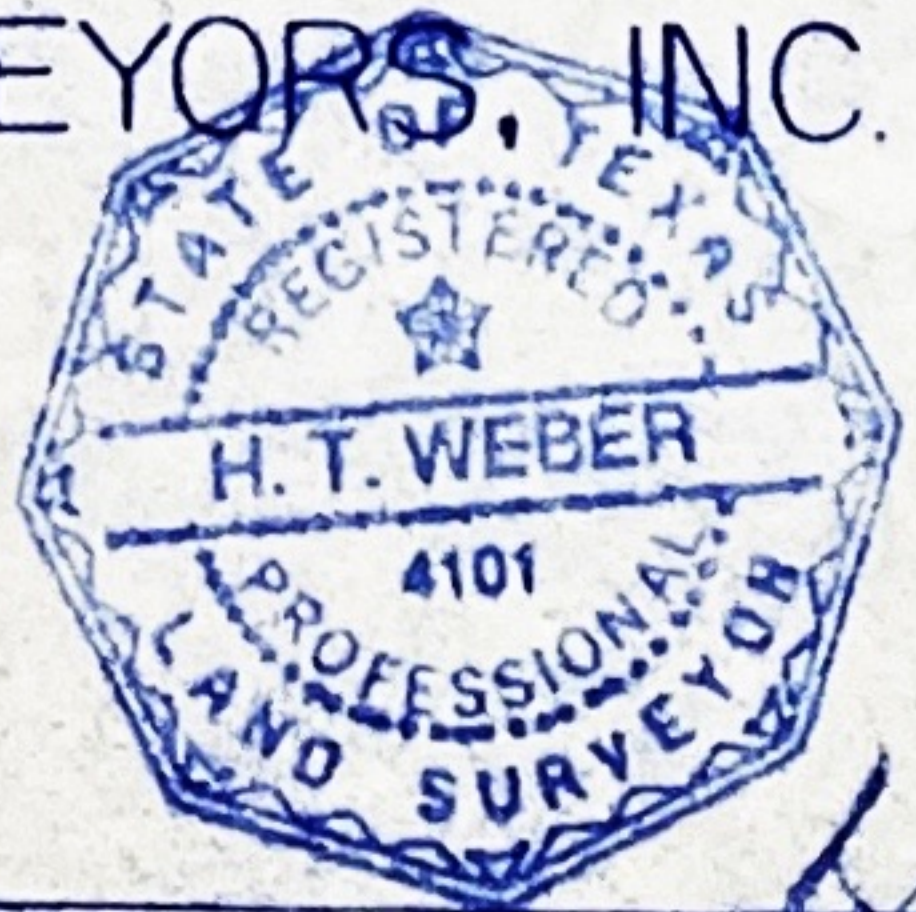

COPYRIGHT © 1992 BY TEXAS STAR SURVEYORS, INC.
I do hereby certify that this survey was this day made on the ground of the property locally described hereon (or on the attached sheet), and is correct and there are no encroachments unless shown.
Notes: There are no natural drainage courses on this property.
Note: This property does not lie in a flood hazard zone according to M.U.D.F.A. 48157C0120J 01-03-97

JOB # 9101188

ZONE X

	DATE	BY
FIELD WORK	10-21-98	MC
DRAFTING	10-23-98	GRB
FINAL CHECK		

H.T. Weber