

TNT Home Appraisal Appraisals Sketch Services Report

Date: 7/16/2024

Client: Rauf Diab

Re: Living Area Square Footage Measurement
21306 Park Orchard Dr, Katy TX 77450

Per request, I have measured the subject property referenced above to calculate the living area square footage of the residence. I measured the subject property using a laser measuring device and the resulting measurements and the calculation of living area square footage are contained on the second page of this report.

The calculated living area square footage approximately represents the air-conditioned area of the residence, including exterior walls, but excluding parking areas, porch/patio areas, and unfinished areas. Note that variances in the calculation of living area square footage may occur among appraisers and other professionals due to the rounding of measurements and the varying methods of measuring common features such as stairwells, second floors, garage areas, and additions. TNT Home Appraisal Services has made a good faith effort to ascertain the living area square footage of the subject property. TNT Home Appraisal Services is not responsible for differing living area square footage calculations obtained from other appraisers or professionals.

This report is not an opinion of value or representation of the adequacy or inadequacy of the subject property for any purpose. This report only presents the approximation of living area square footage of the subject property. This report is intended for the exclusive use of the client named above. If you have any questions regarding the calculation of the living area square footage of the subject property, please do not hesitate to contact me.



Theresa Reece, 1340631 TX

Building Sketch

Borrower/Client				
Property Address 21306 Park Orchard Dr				
City	Katy	County	Harris	State TX Zip Code 77450
Lender				

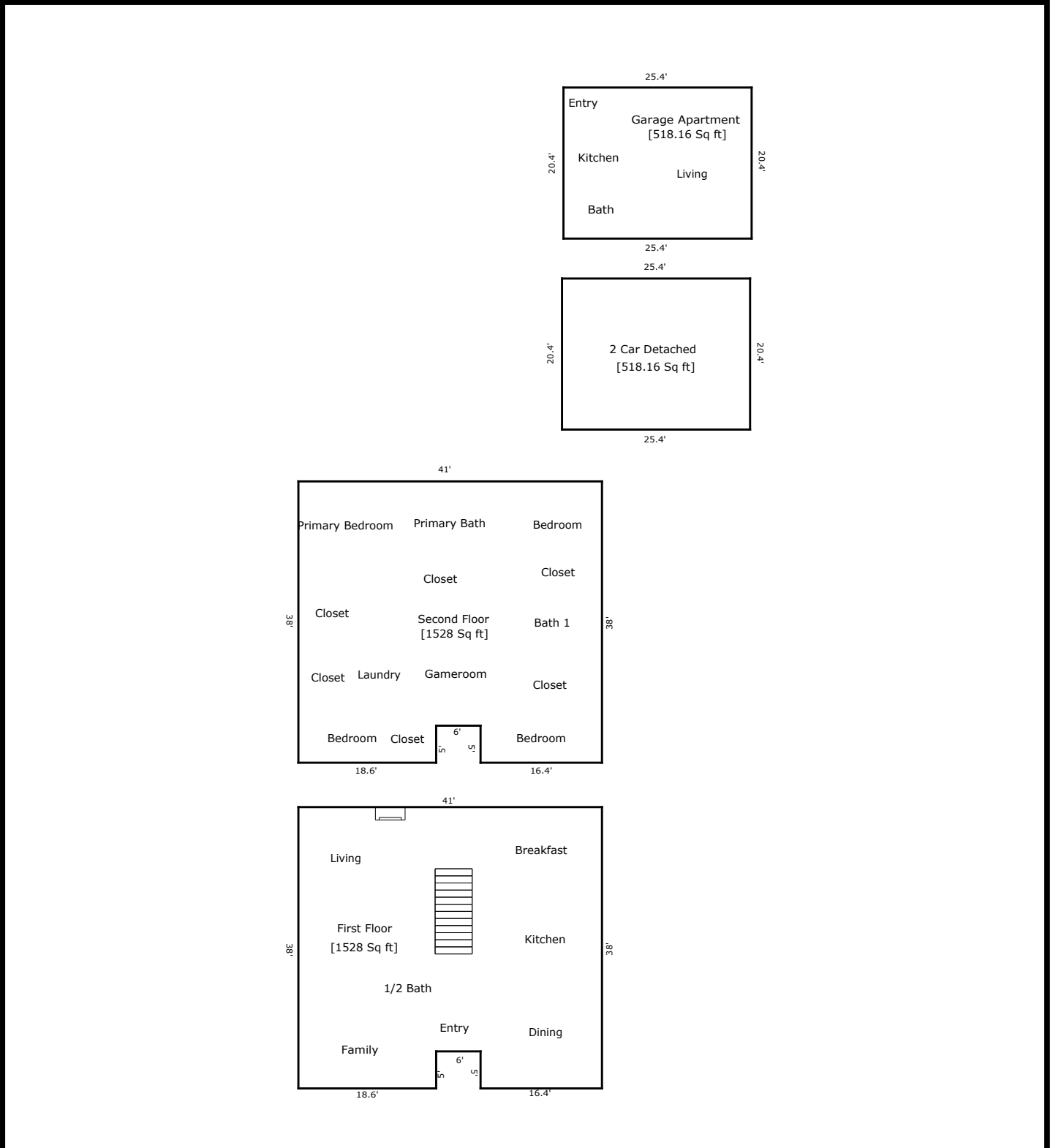

TOTAL Sketch by a la mode, inc.

Area Calculations Summary

Living Area		Calculation Details
First Floor	1528 Sq ft	$41 \times 33 = 1353$ $5 \times 18.6 = 93$ $5 \times 16.4 = 82$
Second Floor	1528 Sq ft	$41 \times 33 = 1353$ $5 \times 18.6 = 93$ $5 \times 16.4 = 82$
Garage Apartment	518.16 Sq ft	$20.4 \times 25.4 = 518.16$
Total Living Area (Rounded):	3574 Sq ft	
Non-living Area		
2 Car Detached	518.16 Sq ft	$20.4 \times 25.4 = 518.16$