

LOT 68, BLOCK 1
ENCHANTED HARBOR

LOT 67, BLOCK 1
ENCHANTED HARBOR

FOUND 5/8"
IRON ROD AT
N 73°44'28" W
0.21'

FOUND 5/8"
IRON ROD AT
S 72°07'00" W
0.51'

N 25°47'19" E 56.58'

POWER POLE

LOT 34
BLOCK 1

SHED

LOT 33

LOT 35

SEPTIC
TANK

N 72°47'15" W 151.61'

S 72°47'15" E 151.61'

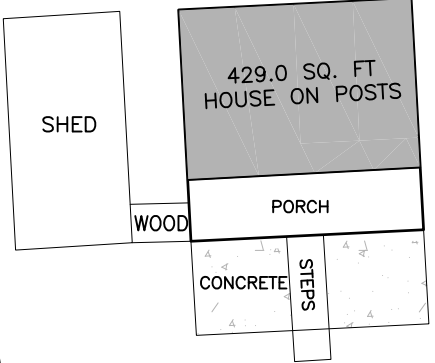

S 25°47'37" W 56.58'

FOUND 5/8"
IRON ROD

WATER
METER

FOUND 1/2"
IRON ROD AT
N 09°10'23" E
1.61'

MARSHALL JOHNSON AVE

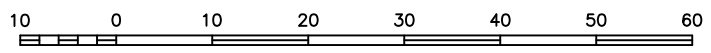

SCALE: 1" = 20 FEET

I HEREBY STATE THAT THIS PLAT SHOWS THE
SUBJECT LOCATION AS SURVEYED ON THE GROUND
02/24/17. THIS PLAT IS TRUE AND CORRECT TO
THE BEST OF MY KNOWLEDGE.

COLE E. BARTON
REGISTERED PROFESSIONAL LAND SURVEYOR
LICENSE NO. 6368

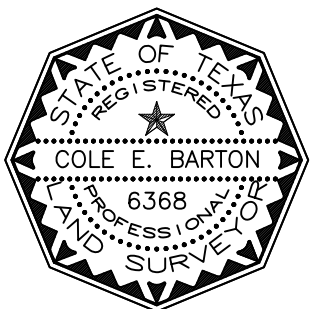

**BARTON
& ASSOCIATES**
LAND SURVEYING

2321 TROPICAL WIND DRIVE, CORPUS CHRISTI, TX 78414 | (361) 293-1117
TEXAS LICENSED SURVEYING FIRM 10194009
THE INTERSECTION OF QUALITY AND EFFICIENCY

LOT 34, BLOCK 1

MARSHALL - JOHNSON SUBDIVISION OF CARRANCHUA BEACH,
AS SHOWN BY THE MAP OR PLAT THEREOF RECORDED IN VOL.
Z, PG. 105, MAP RECORDS OF CALHOUN COUNTY, TEXAS.

Completion Date: 03/02/17	File Name: JOHNSONAVE.DWG
Scale: 1"=20'	Surveyed by: ST/LB
Drawn by: AF	Checked by: CB

JOB #: 1702030