

YUMA CREST LANE
(50' R.O.W.)

LEGEND:

—●—	WIRE FENCE	▨	ASPHALT
—○—	CHAIN LINK FENCE	▩	CONCRETE
—○—	WROUGHT IRON FENCE	▧	GRAVEL
—	WOOD FENCE	▤	TILE
—	VINYL FENCE	▥	WOOD
—	ELECTRIC LINE	▦	BRICK
—	CM - GAS METER	▧	STONE
—	EM - ELECTRIC METER	▨	RAILROAD TIE
—	IPF - IRON PIPE FOUND		
—	IRF - IRON ROD FOUND		
—	IRS - IRON ROD SET		
—	CM - CONTROLLING MONUMENT (WOOD)		

NOTES:
BEARINGS ARE BASED ON THE RECORDED PLAT.
BUILDING LINES AND EASEMENTS ARE BASED ON THE RECORDED PLAT UNLESS OTHERWISE NOTED

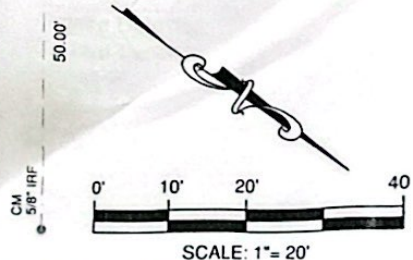

LEGAL DESCRIPTION
BEING LOT 12, BLOCK 2, CANYON GATE AT NORTHPOINTE, SECTION FOUR, AN ADDITION IN HARRIS COUNTY, TEXAS, ACCORDING TO THE MAP OR PLAT RECORDED IN FILM CODE 409029, MAP RECORDS OF HARRIS COUNTY, TEXAS

GF NO	16 275721 HC
BORROWER	ANITA RHOJAS & SANDRA JEAN AGU
TECH	SY
FIELD	DT

SURVEYOR'S CERTIFICATION
THIS IS TO CERTIFY THAT ON THIS DATE A SURVEY WAS MADE ON THE GROUND, UNDER MY SUPERVISION AND REFLECTS A TRUE AND CORRECT REPRESENTATION OF THE DIMENSIONS AND CALLS OF PROPERTY LINES AND LOCATION AND TYPE OF IMPROVEMENTS. THERE ARE NO VISIBLE AND APPARENT EASEMENTS, CONFLICTS, INTRUSIONS OR PROTRUSIONS, EXCEPT AS SHOWN. THIS SURVEY IS NOT TO BE USED FOR CONSTRUCTION PURPOSES AND IS FOR THE EXCLUSIVE USE OF THE HEREON NAMED PURCHASER, MORTGAGE COMPANY, AND TITLE COMPANY ONLY AND THIS SURVEY IS MADE PURSUANT TO THAT CERTAIN TITLE COMMITMENT UNDER THE GF NUMBER SHOWN HEREON. PROVIDED BY THE TITLE COMPANY NAMED HEREON AND THAT THIS DATE, THE EASEMENTS, RIGHTS OF WAY, OR OTHER LOCATABLE MATTERS OF RECORD THAT THE UNDERSIGNED HAS KNOWLEDGE OR HAS BEEN ADVISED ARE AS SHOWN OR NOTED HEREON THIS SURVEY IS SUBJECT TO ANY AND ALL COVENANTS AND RESTRICTIONS PERTAINING TO THE RECORDED PLAT REFERENCED HEREON.

FLOOD INFORMATION
THE SUBJECT PROPERTY DOES NOT APPEAR TO WITHIN THE LIMITS OF A 100 YEAR FLOOD HAZAR ZONE ACCORDING TO THE MAP PUBLISHED BY THE FEDERAL EMERGENCY MANAGEMENT AGENCY, A HAS A ZONE "X" RATING AS SHOWN BY MAP NO. 48201C0240 M, DATED OCTOBER 16, 2013.

DATE: 10-18-16 JOB NO: 16-08315
FIELD: 10-17-16

19411 YUMA CREST LANE, TOMBALL, TX 77377
LOT 12, BLOCK 2,
CANYON GATE AT NORTHPOINTE, SECTION FOUR

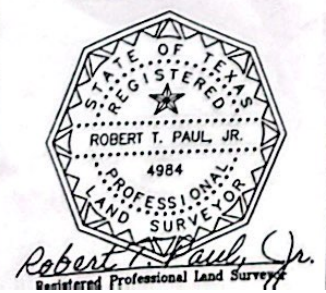

Capital Title
A Shaddock Company

DATE: _____
ACCEPTED BY: _____

Premier
TITLE INSURANCE

5700 W. Plano Parkway
Suite 2700
Plano, Texas 75093
Office: 972-612-3601
Fax: 972-964-1011