

Building Sketch (Page - 1)

Borrower				
Property Address 5915 Majestic Pines Dr				
City	Kingwood	County	Harris	State TX Zip Code 77345-3303
Lender/Client				

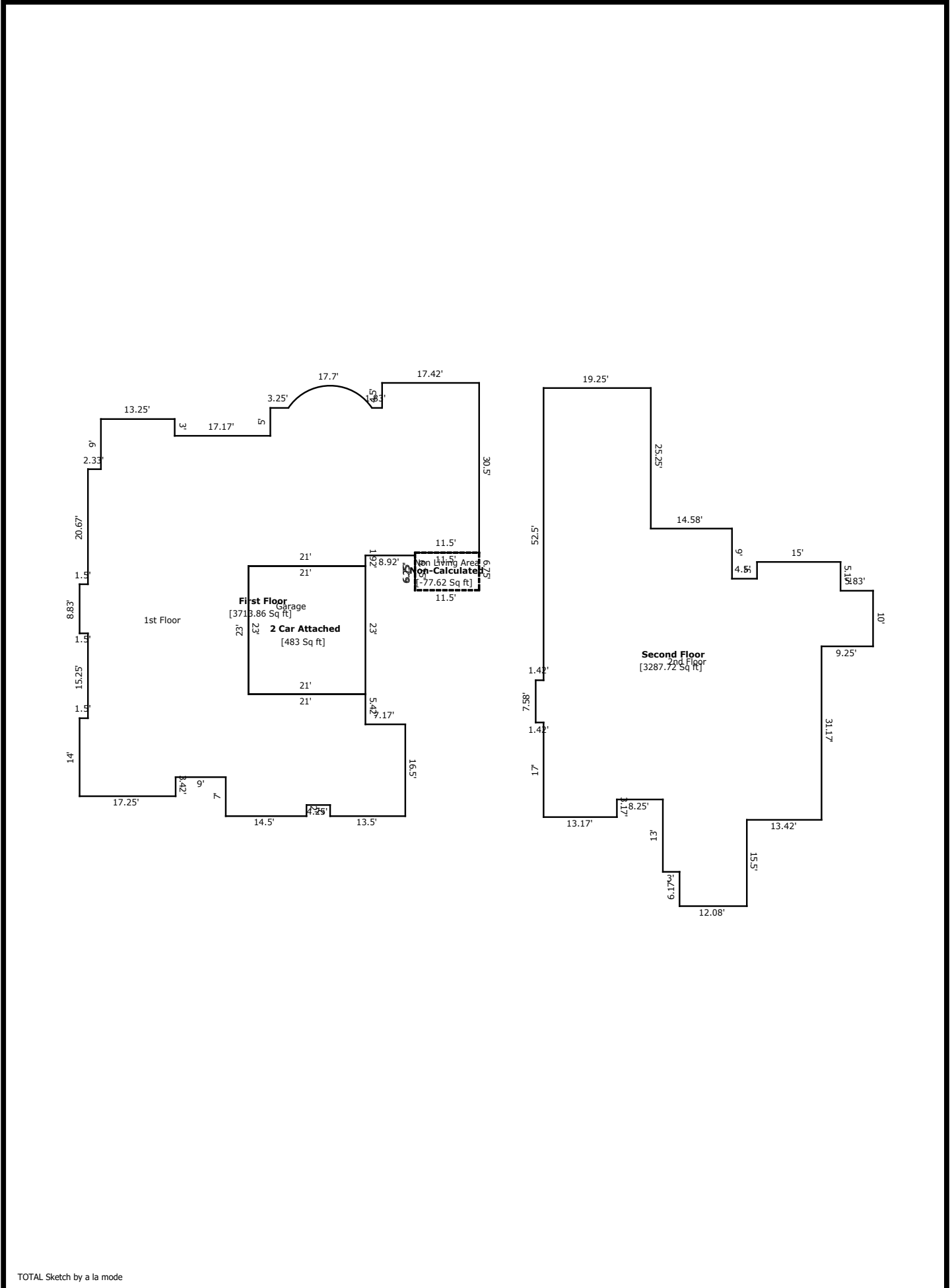

Building Sketch (Page - 2)

Borrower				
Property Address 5915 Majestic Pines Dr				
City	Kingwood	County	Harris	State TX Zip Code 77345-3303
Lender/Client				

TOTAL Sketch by a la mode

Area Calculations Summary

Living Area	Calculation Details		
First Floor	3713.86 Sq ft		
		8.83 × 1.5 =	13.25
		30.5 × 11.5 =	350.75
		5.92 × 4.5 =	26.63
		26.5 × 8.92 =	236.29
		16.5 × 7.17 =	118.25
		28.42 × 17.08 =	485.45
		6.33 × 2 =	12.67
		19.92 × 10.58 =	210.78
		14.5 × 7 =	101.5
		14.92 × 10.42 =	155.38
		13.25 × 3 =	39.75
		17.25 × 3.42 =	58.94
		30.33 × 10.58 =	321.03
		28.83 × 27.33 =	788.11
		23.42 × 30.42 =	712.26
		2.33 × 17.42 =	40.64
		Negative Arc =	42.19
Second Floor	3287.72 Sq ft		
		7.58 × 1.42 =	10.74
		19.25 × 25.25 =	486.06
		10 × 5.83 =	58.33
		12.08 × 6.17 =	74.51
		15.08 × 9.33 =	140.78
		33.83 × 9 =	304.5
		42.83 × 13.17 =	563.97
		15.17 × 3.42 =	51.82
		11.58 × 3 =	34.75
		36.75 × 39.67 =	1457.75
		3.67 × 28.5 =	104.5
Total Living Area (Rounded):	7002 Sq ft		
Non-living Area			
2 Car Attached	483 Sq ft	23 × 21 =	483

