

Building Sketch (Page - 1)

Borrower					
Property Address		28 Shorelake Dr			
City	Kingwood	County	State	TX	Zip Code 77339
Lender/Client					

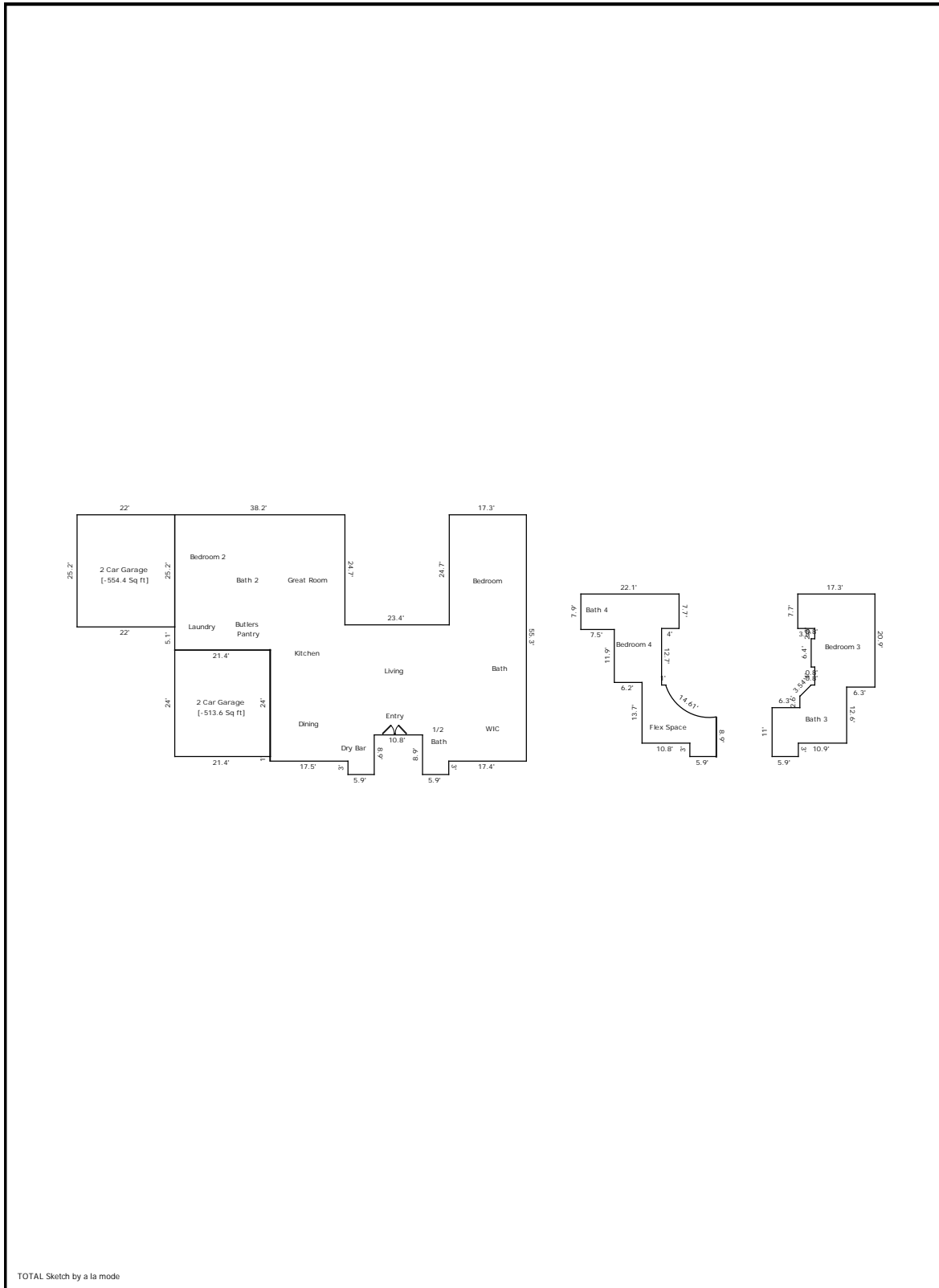

Building Sketch (Page - 2)

Borrower					
Property Address	28 Shorelake Dr				
City	Kingwood	County		State	TX
				Zip Code	77339
Lender/Client					

Living Area		Calculation Details
2 Car Garage	-554.4 Sq ft	25.2 × 22 = 554.4
First Floor	3221.87 Sq ft	30.3 × 21.4 = 648.42 16.8 × 24.7 = 414.96 17.3 × 24.7 = 427.31 30.6 × 17.5 = 535.5 40 × 24.7 = 988 8.9 × 5.9 = 52.51 8.9 × 5.9 = 52.51 5.9 × 17.4 = 102.66
2 Car Garage	-513.6 Sq ft	24 × 21.4 = 513.6
Second Floor	515.46 Sq ft	6.4 × 0.8 = 5.12 11 × 5.9 = 64.9 10.9 × 8 = 87.2 7.7 × 3.8 = 29.26 13.5 × 20.4 = 275.4 10.5 × 2.6 = 27.3 0.5 × 6.3 = 3.15 2.5 × 8 = 20 0.5 × 2.5 × 2.5 = 3.12
Third Floor	475.42 Sq ft	7.9 × 7.5 = 59.25 14.6 × 7.7 = 112.42 10.6 × 12.1 = 128.26 5.9 × 3 = 17.7 16.7 × 5.9 = 98.53 7.8 × 4.4 = 34.32 7.2 × 1 = 7.2 0.5 × 7.2 × 11.3 = 40.68 Negative Arc = 22.94
Total Living Area (Rounded):	4213 Sq ft	

ABBIE GAIL HAWKINS
6607 EMERALD ASH COURT
HUMBLE, TX 77346



**Certified Residential
Real Estate Appraiser**

Appraiser: **ABBIE GAIL HAWKINS**
License #: **TX 1338340 R** License Expires: **03/31/2025**

Having provided satisfactory evidence of the qualifications required by the Texas Appraiser Licensing and Certification Act, Occupations Code, Chapter 1103, authorization is granted to use this title:
Certified Residential Real Estate Appraiser

For additional information or to file a complaint please contact TALCB at www.talcb.texas.gov.



**Chelsea Buchholtz
Commissioner**