

SITE #24  
 WINTERAL RESERVE  
 EASEMENT: 5.00 AC  
 CC# NO. 2001-022710  
 P.P.M.C.

3



SCALE: 1" = 100'  
 DATE: 1/5/05

- NOTES:
1. ALL BUILDING LINES AND EASEMENTS ARE PER THE RECORDED PLAT UNLESS OTHERWISE SHOWN.
  2. ACCESS TO AND FROM GRAND LAKE ESTATES IS PROHIBITED AS PER THE RECORDED PLAT.
  3. STREETS ARE DEDICATED AS UTILITY EASEMENTS AS PER THE RECORDED PLAT.

GRAND LAKE ESTATES DRIVE  
 CONTROL MONUMENT  
 FOUND IRON ROD  
 N38°10'42"W 200.47'

(60' PRIVATE R.O.W.)  
 R=830.00' D=22°40'40" L=328.57'  
 Ch=N26°50'22"W 326.37'

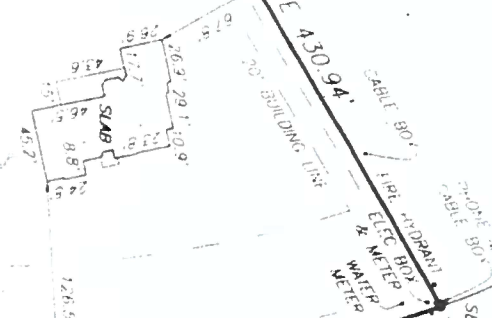

BLOCK 4

562°39'49"  
 151.95'  
 SET 5/8" IRON ROD W/CAP

R=530.00' D=24°01'33" L=222.24'  
 Ch=S11°46'40"E 220.62'

500'14'06"W 160.13'

R=850.22' D=20°55'51" L=310.60'  
 Ch=S10°13'49"E 308.87'

MAJESTIC DRIVE (60' PRIVATE R.O.W.)

NATURAL DRAINAGE

5