



M  
MARLOWE

FOUR SEASONS  
HOTEL

MARLOWE

CANNAN  
PROPERTIES

WORK • LIVE • PLAY • OWN DOWNTOWN

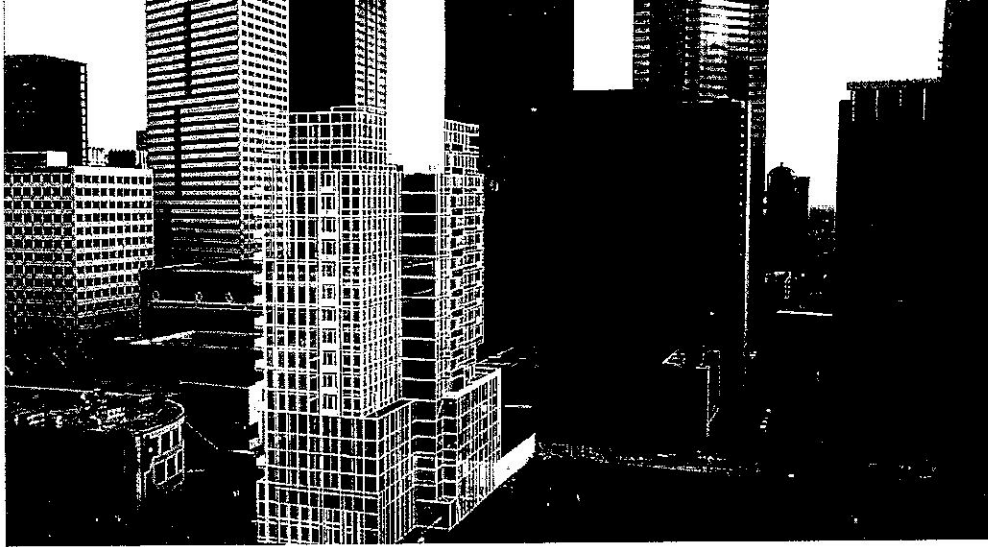

In the heart of Houston's central business district, the Marlowe is just blocks away from sports arenas, concert venues, spiritual centers, the Discovery Green Park, and restaurants.

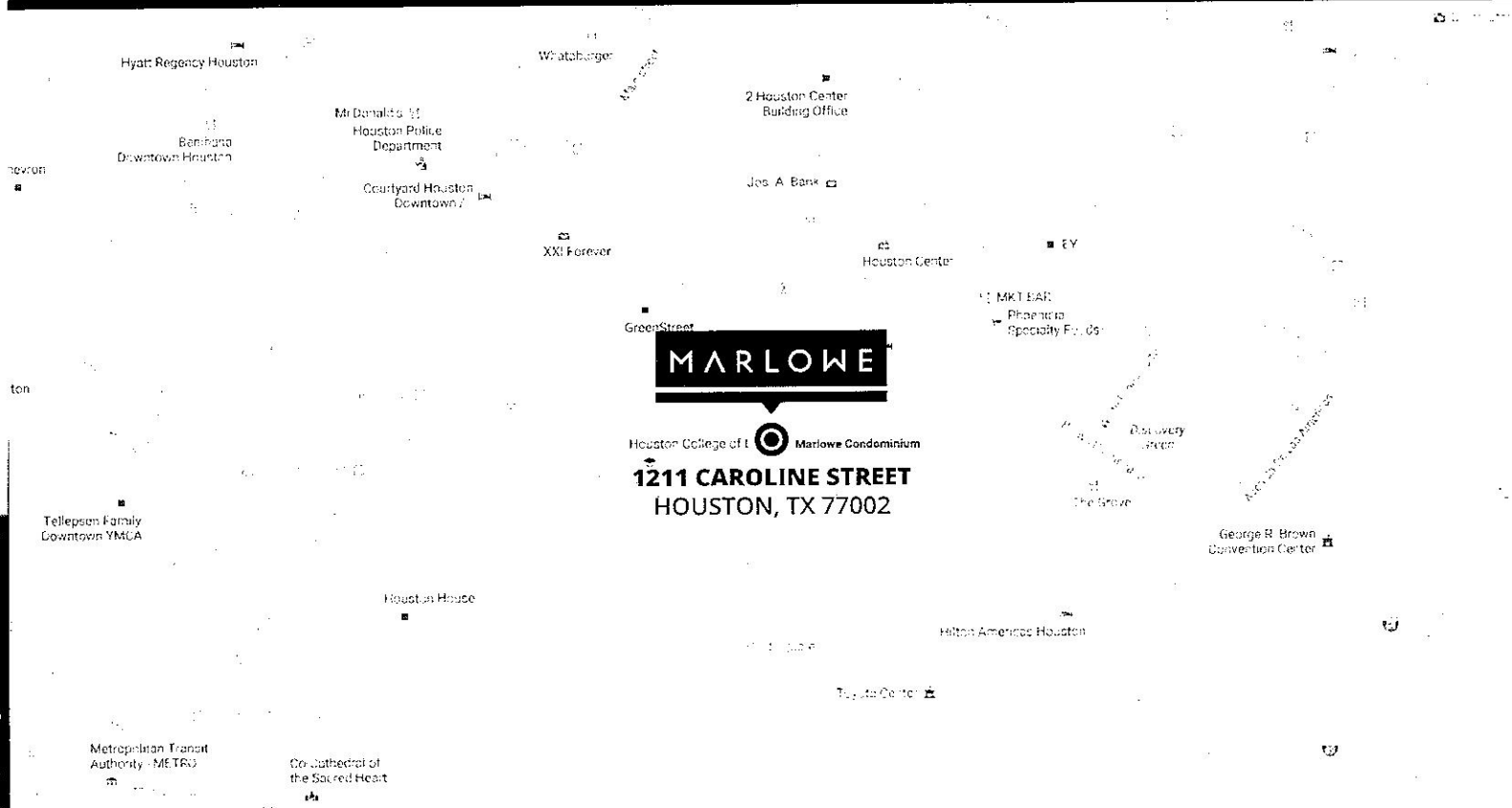

# BUILDING SPECIFICATIONS



---

FLOORS: 20

---

PARKING: 162

---

RESIDENCES: 96

---

PENTHOUSES: 8

Luxury living at its best! With sophisticated finishes and outstanding services and amenities, the Marlowe makes for a great home.



# BUILDING FEATURES



MARLOWE

24-HOUR CONCIERGE

VALET PARKING

PRIVATE GARAGES AVAILABLE

STORAGE UNITS AVAILABLE

DOWNTOWN, CITY AND DISCOVERY VIEWS

MODERN ARCHITECTURE

PIED-A-TERRE FOR GUESTS

STARLIGHT POOL AND HOT TUB

STATE OF THE ART FITNESS CENTER

STEAM ROOM

SAUNA

FIRE PIT



# STANDARD FEATURES



MARLOWE

SOARING 10' CEILINGS WITH 10' GLASS (ONLY ON FRONT ELEVATION)  
LOW - VOLTAGE LIGHTING  
BOSCH APPLIANCES  
GAS RANGE / COOKTOP  
IMPORTED CABINETRY  
HARDWOOD FLOORS IN LIVING AREA  
FRAMELESS SHOWER DOORS IN ALL MASTER BATHS

