

FLOORPLAN SKETCH

Borrower: N/A

File No.: M2405006

Property Address: 5755 Valkeith Dr

Case No.:

City: Houston

State: TX

Zip: 77096

Lender: N/A

Sketch

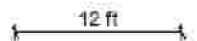
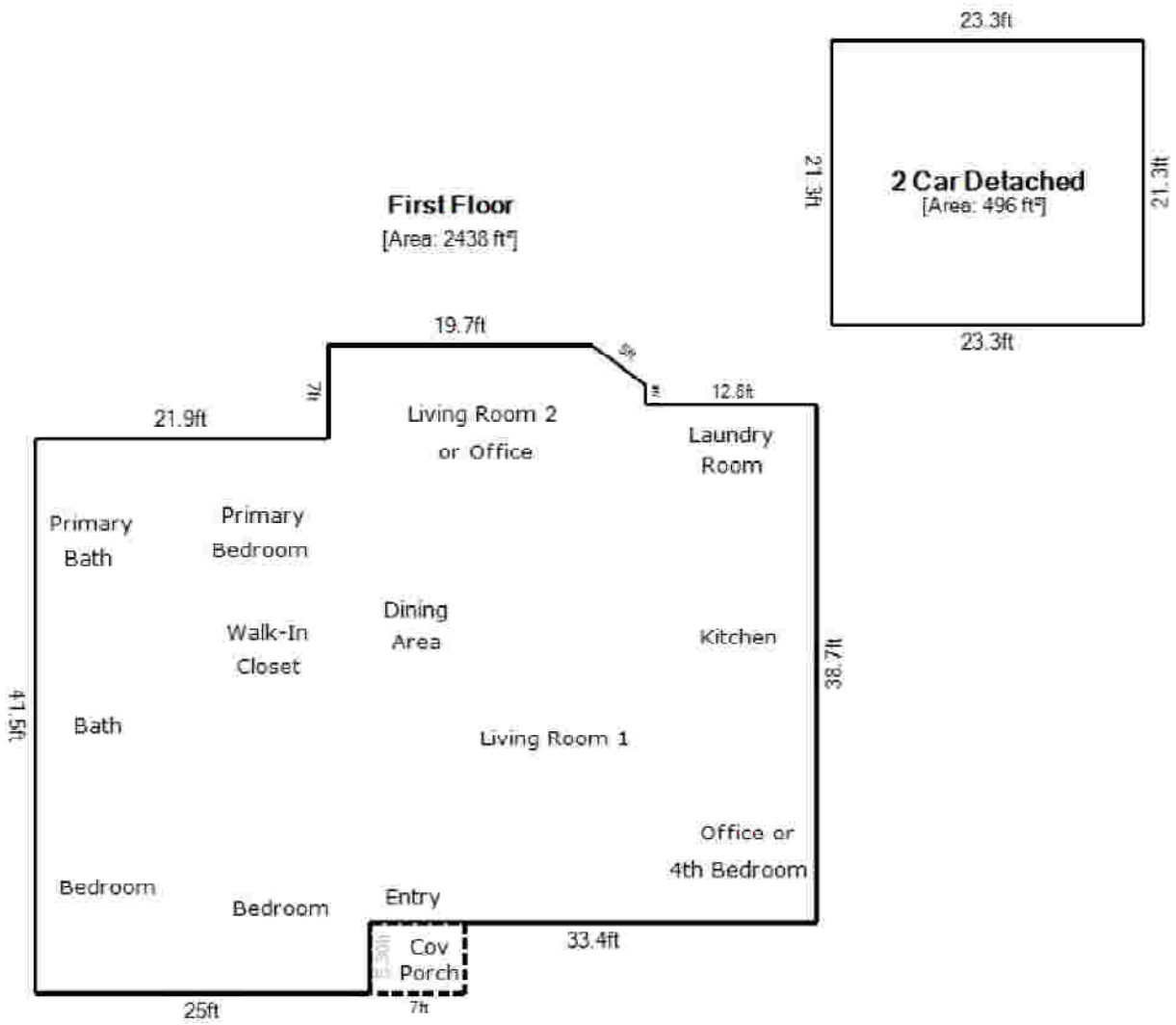

Living Area		Area Calculation			
First Floor	2438.48 ft <sup>2</sup>	First Floor			x 1.00 = 2438.48 ft <sup>2</sup>
Nonliving Area		△	1.5ft x 5ft	0.40 =	3 ft <sup>2</sup>
2 Car Detached	496.29 ft <sup>2</sup>	□	33.4ft x 38.7ft	1.00 =	1292.68 ft <sup>2</sup>
Covered Porch	37.10 ft <sup>2</sup>	□	2.6ft x 3.10ft	1.00 =	7.75 ft <sup>2</sup>
		△	41.5ft x 26ft	0.60 =	518.75 ft <sup>2</sup>
		△	41.5ft x 26ft	0.60 =	518.75 ft <sup>2</sup>
		△	4ft x 6.02ft	0.37 =	9 ft <sup>2</sup>
<b>Total Living Area (rounded):</b>	<b>2438 ft<sup>2</sup></b>	□	19.7ft x 4.6ft	1.00 =	88.65 ft <sup>2</sup>

**APPRAISER'S CERTIFICATION**

Borrower: N/A

File No.: M2405006

Property Address: 5755 Valkeith Dr

Case No.:

City: Houston

State: TX

Zip: 77096

Lender: N/A



**Certified Residential  
Real Estate Appraiser**

**Appraiser: Krista Lynn Lancton**

**License #: TX 1337511 R**

**License Expires: 11/30/2025**

Having provided satisfactory evidence of the qualifications required by the Texas Appraiser Licensing and Certification Act, Occupations Code, Chapter 1103, authorization is granted to use this title:  
Certified Residential Real Estate Appraiser

**Chelsea Buchholtz  
Commissioner**

For additional information or to file a complaint please contact TALCB at [www.talcb.texas.gov](http://www.talcb.texas.gov).