

# Survey



**LEGEND:**

—●—	WIRE FENCE	▨	ADJACENT RESIDENCE
—○—	CHAINLINK FENCE	▨	ASPHALT
—□—	WROUGHT IRON FENCE	▨	CONCRETE
—◇—	WOOD FENCE	▨	GRAVEL
—V—	VINYL FENCE	▨	TILE
—E—	ELECTRIC LINE	▨	WOOD
GM	GAS METER	▨	BRICK
EM	ELECTRIC METER	▨	STONE
IRP	IRON PIPE FOUND	▨	RAILROAD TIE
IRF	IRON ROD FOUND		
IRB	IRON ROD SET W/ CAP "PREMIER"		
CM	CONTROLLING MONUMENT		

**NOTES:**  
 BEARINGS ARE BASED ON THE RECORDED PLAT.  
 BUILDING LINES AND EASEMENTS ARE BASED ON THE RECORDED PLAT UNLESS OTHERWISE NOTED.

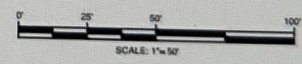

**LEGAL DESCRIPTION:**  
 BEING LOTS 79 AND 80, OF PITCAIRN, A SUBDIVISION IN HARRIS COUNTY, TEXAS, ACCORDING TO THE MAP OR PLAT THEREOF RECORDED IN VOLUME 132, PAGE 47, OF THE MAP RECORDS OF HARRIS COUNTY, TEXAS.

**SURVEYOR'S CERTIFICATION:**  
 THIS IS TO CERTIFY THAT ON THIS DATE A SURVEY WAS MADE ON THE GROUND, UNDER MY SUPERVISION AND REFLECTS A TRUE AND CORRECT REPRESENTATION OF THE DIMENSIONS AND CALLS OF PROPERTY LINES AND LOCATION AND TYPE OF IMPROVEMENTS. THERE ARE NO VISIBLE AND APPARENT EASEMENTS, CONFLICTS, INTRUSIONS OR PROTRUSIONS, EXCEPT AS SHOWN. THIS SURVEY IS NOT TO BE USED FOR CONSTRUCTION PURPOSES AND IS FOR THE EXCLUSIVE USE OF THE HEREON NAMED PURCHASER, MORTGAGE COMPANY, AND TITLE COMPANY ONLY AND THIS SURVEY IS MADE PURSUANT TO THAT CERTAIN TITLE COMMITMENT UNDER THE GF NUMBER SHOWN HEREON, PROVIDED BY THE TITLE COMPANY NAMED HEREON AND THAT THIS DATE, THE EASEMENTS, RIGHTS-OF-WAY, OR OTHER LOCATABLE MATTERS OF RECORD THAT THE UNDERSIGNED HAS KNOWLEDGE OR HAS BEEN ADVISED ARE AS SHOWN OR NOTED HEREON. THIS SURVEY IS SUBJECT TO ANY AND ALL COVENANTS AND RESTRICTIONS PERTAINING TO THE RECORDED PLAT REFERENCED HEREON.

GF. NO.	17-202283-HC
BORROWER	ROBERT K. VANDERFORD KIMBERLY K. VANDERFORD
TECH	STS
FIELD	DT

**FLOOD INFORMATION:**  
 THE SUBJECT PROPERTY DOES NOT APPEAR TO LIE WITHIN THE LIMITS OF A 100-YEAR FLOOD HAZARD ZONE ACCORDING TO THE MAP PUBLISHED BY THE FEDERAL EMERGENCY MANAGEMENT AGENCY, AND HAS A ZONE "X" RATING AS SHOWN BY MAP NO. 48201C0240 M, DATED OCTOBER 16, 2013.

DATE: 03/09/17  
 FIELD: 03/08/17  
 JOB NO.: 17-01697

12702 ISLAND DRIVE, TOMBALL, TX 77377  
 LOTS 79 AND 80, PITCAIRN

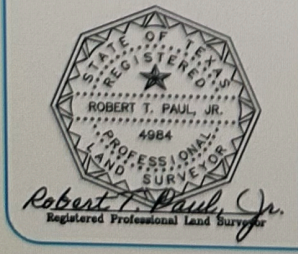

DATE: \_\_\_\_\_  
 ACCEPTED BY: \_\_\_\_\_

Premier Surveying, LLC  
 5700 W. Plano Parkway  
 Suite 2700  
 Plano, Texas 75093  
 Office: 972-414-2601  
 Fax: 972-94-2601  
 Firm Registration