

Building Sketch (Page - 1)

Client	Polly Richards			
Property Address	6002 Pin Oak PI			
City	Spring	County	Harris	State TX Zip Code 77379
Appraiser	Jill Harvey			

The measuring methodology and criteria used in this report meets the Square Footage-Method for Calculating: ANSI@ Z765-2021.

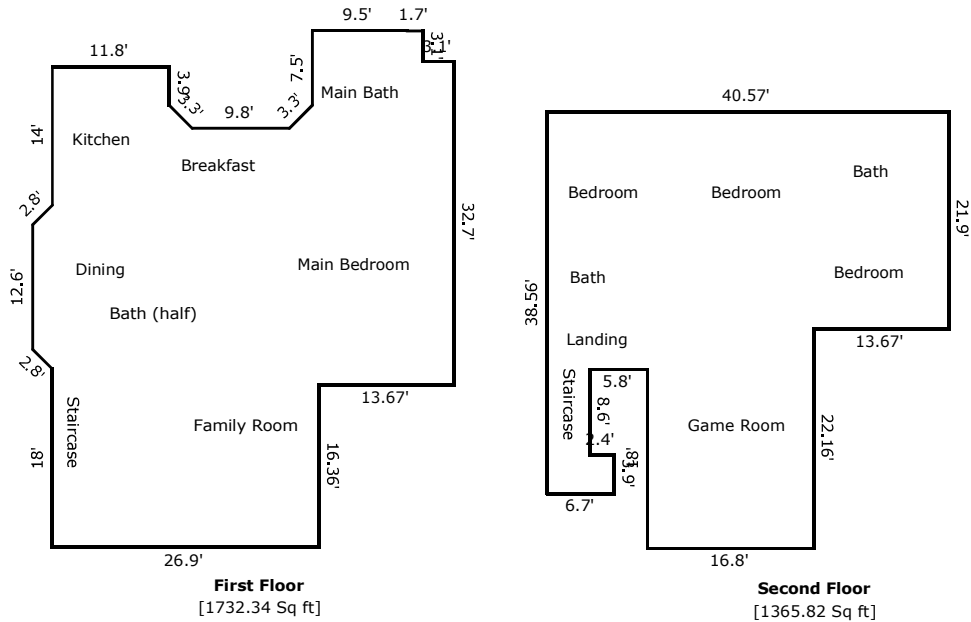

Room Labels are for Illustration Purposes Only
 GLA Calculations: The living area of the improvements is calculated utilizing field measurements (or architects plans if proposed construction). These dimensions are inherently inaccurate due to rounding errors, errors in measuring devices and adjustments that must be made to "square drawing".
 The more complex the design of the improvements, the greater these errors may be.
 These estimated GLA provided is an estimate only. It may differ from an estimate provided by builders, tax authorities or even a different appraiser. The GLA is an estimate only and should not be relied on as if fact.

TOTAL Sketch by a la mode, inc.

Area Calculations Summary

Living Area		Calculation Details
First Floor	1732.34 Sq ft	$0.5 \times 1.98 \times 1.98 = 1.96$ $0.5 \times 1.98 \times 1.98 = 1.96$ $12.6 \times 1.98 = 24.95$ $26.9 \times 16.36 = 440.08$ $40.57 \times 25.97 = 1053.38$ $6.73 \times 3.1 = 20.87$ $9.83 \times 11.2 = 110.14$ $0.5 \times 2.33 \times 2.33 = 2.72$ $6.23 \times 11.8 = 73.56$ $0.5 \times 2.33 \times 2.33 = 2.72$
Second Floor	1365.82 Sq ft	$16.8 \times 18 = 302.4$ $21.9 \times 13.67 = 299.31$ $26.9 \times 26.06 = 701.01$ $3.9 \times 2.4 = 9.36$ $12.5 \times 4.3 = 53.75$
Total Living Area (Rounded):	3098 Sq ft	