

PLAT SHOWING SURVEY OF LOT 8, AND LOT 9, BLOCK ONE, OF BRIDGEPOINT SECTION ONE, ACCORDING TO THE MAP OR PLAT RECORDED IN CABINET 1, SHEET 150, OF THE MAP RECORDS OF MONTGOMERY COUNTY, TEXAS, AND BEING IN THE NEIL MARTIN SURVEY A-26, MONTGOMERY COUNTY, TEXAS.

SCALE 1" = 100'

JULY 8, 2005

THIS IS TO CERTIFY THAT THIS SURVEY WAS MADE ON THE GROUND, THAT THIS PLAT CORRECTLY REPRESENTS THE FACTS FOUND AT THE TIME OF THE SURVEY AND THAT THIS PROFESSIONAL SERVICE CONFORMS TO THE SPECIFICATIONS FOR A CATEGORY 1A, CONDITION 4, SURVEY. I FURTHER CERTIFY THAT TO THE BEST OF MY KNOWLEDGE THE LEGAL DESCRIPTION STATED HEREON IS CORRECT, THAT THERE ARE NO KNOWN DISCREPANCIES, CONFLICTS OR SHORTAGES IN AREA OR BOUNDARY LINE OR ANY VISIBLE EASEMENTS, ENCROACHMENTS OR ANY OVERLAPPING OF IMPROVEMENTS OR ANY RIGHT-OF-WAY EXCEPT AS SHOWN HEREON.

R.P.L.S. NO. 4081
 FILE NO. M2627

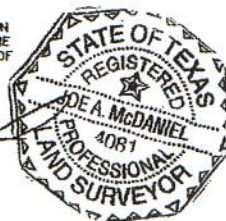

McDANIEL SURVEYING COMPANY
 JOE A. McDANIEL RPLS. NO. 4081

12010 HIGHWAY 105 EAST
 CONROE, TEXAS 77306

PHONE NO. 936-539-6656
 FAX NO. 936-539-6756