

## Building Sketch

Borrower	Jason S Fang			
Property Address	5215 Sanford Rd			
City	Houston	County Harris	State TX	Zip Code 77035
Lender/Client	Thrive Mortgage, LLC			

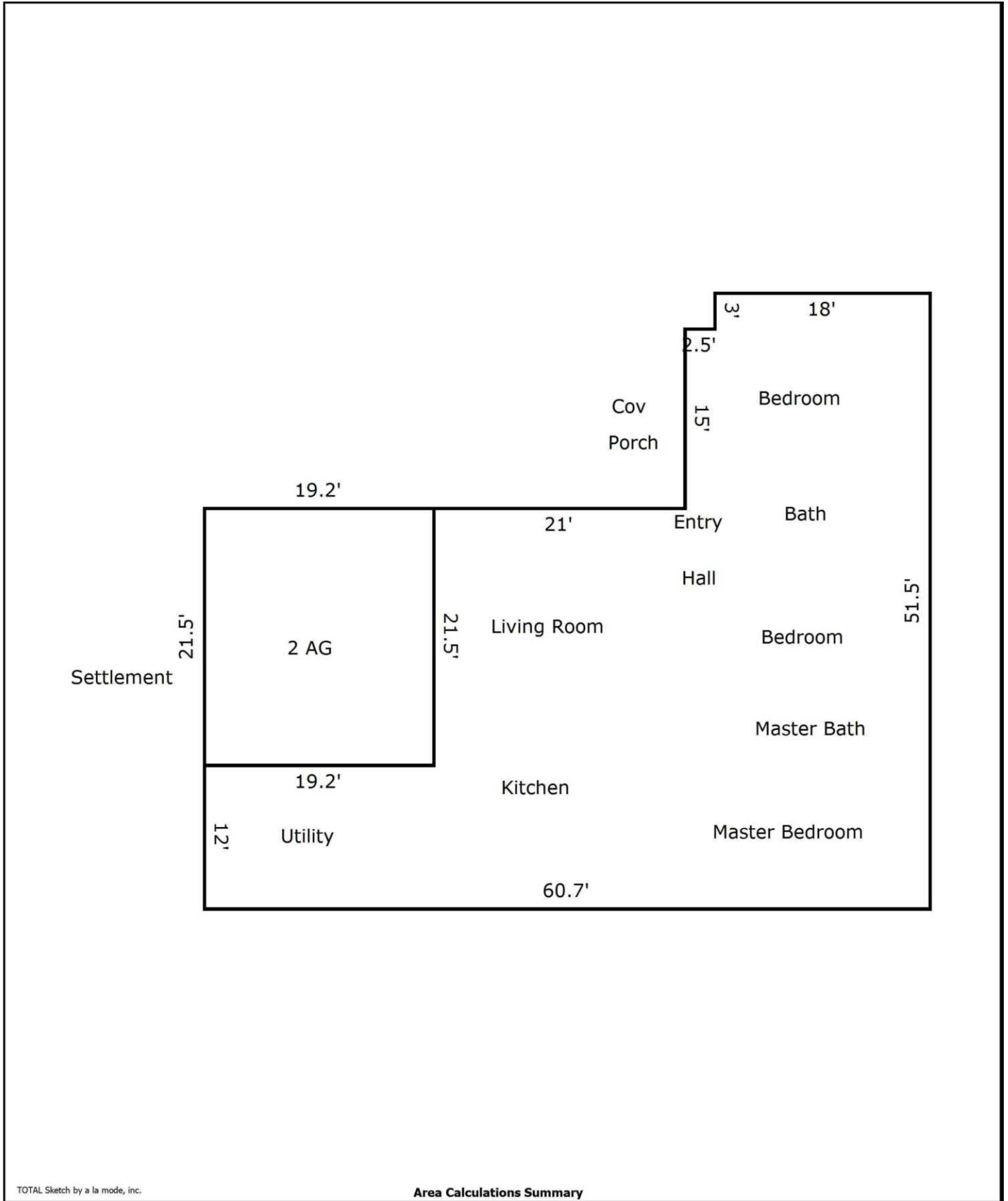

TOTAL Sketch by a la mode, inc.

### Area Calculations Summary

Living Area	Calculation Details	
First Floor	1982.15 Sq ft	$12 \times 19.2 = 230.4$ $41.5 \times 33.5 = 1390.25$ $18 \times 18 = 324$ $15 \times 2.5 = 37.5$
<b>Total Living Area (Rounded):</b>	<b>1982 Sq ft</b>	
Non-living Area		
2 Car Attached	412.8 Sq ft	$19.2 \times 21.5 = 412.8$