

CREEKSIDE 24
SEC 2
BLK 1 N 66°51'55" E
 160.21'

31

23

22

21

20

LAND TITLE SURVEY
 FOR: DANNY B. MCCLOSKEY
 & PAMELA J. MCCLOSKEY
 548 CREEKSIDE DRIVE
 ONALASKA, TEXAS 77360

LOTS TWENTY-ONE (21), TWENTY-TWO (22), AND
 TWENTY-THREE (23), BLOCK ONE (1), SECTION TWO (2)
 OF CREEKSIDE, A SUBDIVISION IN POLK COUNTY, TEXAS
 AS SHOWN BY THE MAP OR PLAT THEREOF RECORDED IN
 VOLUME 4, PAGE 13 OF THE PLAT RECORDS, POLK COUNTY, TEXAS.

POLK COUNTY ABSTRACT
 FILE NO. 202050519
 RESTRICTIVE COVENANTS:
 251/348 DR; 1744/178, 1826/219, 1826/221
 2032/227, 2202/865 OR

QUADRANT SOLUTIONS
 P.O. BOX 1343 WILLIS, TEXAS 77378
 (936) 856-8989
 PROJECT NO.: 520820

I HEREBY CERTIFY THAT THIS SURVEY WAS MADE ON THE GROUND
 UNDER MY SUPERVISION AND THAT THIS DRAWING CORRECTLY
 REPRESENTS THE FACTS FOUND AT THE TIME OF SURVEY.
 20 DECEMBER 2020

REVISED 23 DEC 2020
 PREAMBLE TYPO &
 FLOWAGE ESMT

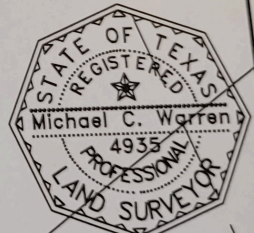

Michael C. Warren
 Registered Professional Land Surveyor No. 4935

