

TITLE SURVEY OF 31.94 ACRES
 BEING ALL OF A CALLED 31.95 ACRE TRACT RECORDED IN VOLUME 944, PAGE 499 D.R.P.C.T. IN THE A VIESCA SURVEY, ABSTRACT 77 POLK COUNTY, TEXAS

CALLLED 17.74 ACRES VOL. 2153, PG. 84 D.R.P.C.T.

SCHEDULE 'B'
 ITEM 10J - DOES NOT CROSS OR TOUCH THIS TRACT.
 ITEM 10K - AS SHOWN ON PLAT.
 ITEM 10L - AS SHOWN ON PLAT.

CALLLED 31.95 ACRES VOL. 883, PG. 595 D.R.P.C.T.

LEGEND
 B/W - BARBED WIRE
 CMF - CONCRETE MONUMENT FOUND
 EM - ELECTRIC METER
 GUY - GUY ANCHOR
 IPF - IRON PIPE FOUND
 OHE - OVERHEAD ELECTRIC
 POB - POINT OF BEGINNING
 PP - POWER POLE
 TJB - TELEPHONE JUNCTION BOX

31.94 ACRES

CALLLED 31.95 ACRES VOL. 944, PG. 499 D.R.P.C.T.

CALLLED 5.995 ACRES VOL. 1167, PG. 282 D.R.P.C.T.

CALLLED 6.000 ACRES VOL. 839, PG. 730 D.R.P.C.T.

NOTE:
 Survey performed in association with First American Title Guaranty Company commitment for title insurance G.F. No. 202048720, dated 3-11-2020. All bearings, distances, and acreages are grid and are referenced to the State Plane Coordinate System, NAD83, Texas Central Zone, U. S. Survey feet. Mapping angle for this project is +02° 47' 01" and the scale factor is 0.999905430. See accompanying field notes. According to FEMA Map 48373C0600C dated 9-3-2010: This property is in flood zone "X".

SCALE: 1" = 200'
 REV1 3-24-2020

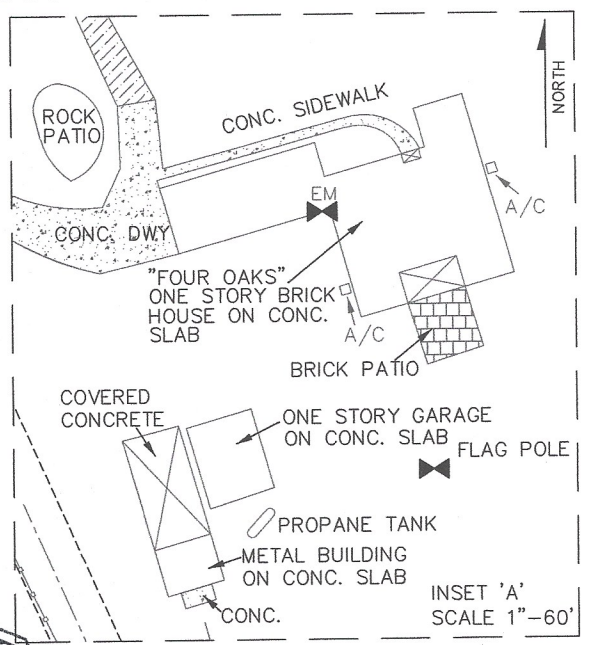

Daniel J Warrick, R.P.L.S.
 PO BOX 1614, Kountze, TX 77625
 210-441-9764 - txsurveyor@yahoo.com
 © Copyright 2020

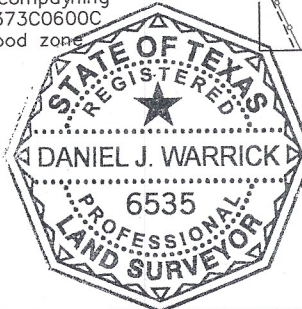

I, Daniel J. Warrick, do hereby certify that this plat reflects an actual survey made on the ground and according to law, and that the limits, boundaries, and corners are truly described just as I found or set them. Given under my hand and seal this 24th day of March, 2020.
Daniel J. Warrick
 Daniel J. Warrick
 Registered Professional Land Surveyor No. 6535