

NOTE: House encroaches over side building line as shown.
 Note: This survey is certified for this transaction only, it is not transferable to additional institutions or subsequent owners.
 Note: By graphic plotting only, this property is not in the 100 year flood plain according to N.F.I.P. Map No.485468 0005E 9-22-99 Zone X
 We do not assume responsibility for exact determination.

BUYER

Stephen B. Woods and,
 Julie A. Woods

1313 Castlewood

DESCRIBED PROPERTY

Lot 13, in Block 13, of WILDERNESS TRAILS, a subdivision in Galveston County, Texas, according to the map or plat thereof, recorded in Volume 15, Page 119 of the Map Records of Galveston County, Texas.

Handwritten signature

TEXAS LAND COORDINATORS, INC.

P.O. BOX 1697 • PEARLAND, TX 77588
 (281) 997-1585

G.F.: 02-31-4487

DATE: 7-9-2002

INV.#: 37959

JOB # 7-65-02

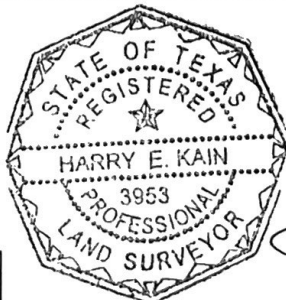

I do hereby certify that this survey was this day made on the ground of the property legally described hereon, (or on the attached sheet), and is correct, and there are no encroachments unless shown, and was done by me or under my supervision, and conforms to or exceeds the current standards as adopted by the Texas Board of Professional Land Surveying.

Handwritten signature: Harry E. Kain 7/10/02
 Harry E. Kain R.P.L.S. #3953