

Survey of Lot Seventy-Four (74), of TIKI ISLAND, SECTION THREE (3), a subdivision in Galveston County, Texas, according to the map or plat thereof recorded in Volume 1616, Page 96, and later transferred to Plat Record 9, Map No. 29, both of the Map Records of Galveston County, Texas.

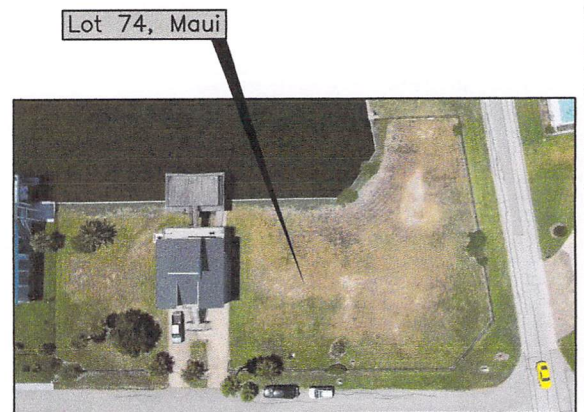

Brene Addison
Brene Addison
Registered Professional
Land Surveyor No. 6598



NOTES:
1) This property is subject the zoning ordinances and/or the building regulations of the Village of Tiki Island. All building setback lines and easements shown are per recorded plat and/or recorded restrictions. If none shown, it is the property owners responsibility to confirm any setback requirements with Village of Tiki Island.
2) This property lies within Zone VE (EL 15') as established by the FEMA Flood Insurance Rate Map No. 48167C0416G, dated August 15, 2019.
3) This property is subject to any restrictions of record and may be subject to setbacks from power lines as established by OSHA and/or the local power company.
4) Bearings are record, as shown on plat of Tiki Island, Section 3, based on the monumentation of the Northeast right-of-way line of Maui.

Legend:

- OHP — Overhead Power
- Chain Link Fence
- - - - Wood Fence
- Concrete
- Electrical Box
- Telecom. Box
- Building Line
- - - - Easement Line
- B.L. Building Setback Line
- U.E. Utility Easement
- A.E. Aerial Easement
- D.E. Drainage Easement
- (N.T.S.) Not to Scale

TRICON LAND SURVEYING, LLC

Mailing: 6341 Stewart Rd. #251
Physical: 2011 59th Street
Galveston, TX 77551
409-497-2772
TriconLandSurveying.com
T.B.P.E.L.S. Firm No. 10194309

Drafting: JA

Parcel ID: 143579

Surveyed for:
Dominic Fan