

# Building Sketch (Page - 1)

Borrower/Client	Gina C Gudmundson		
Property Address	13315 Coolidge Creek Dr		
City	Tomball	County	Harris
		State	TX
		Zip Code	77377
Lender	HomeBridge Financial Services, Inc		

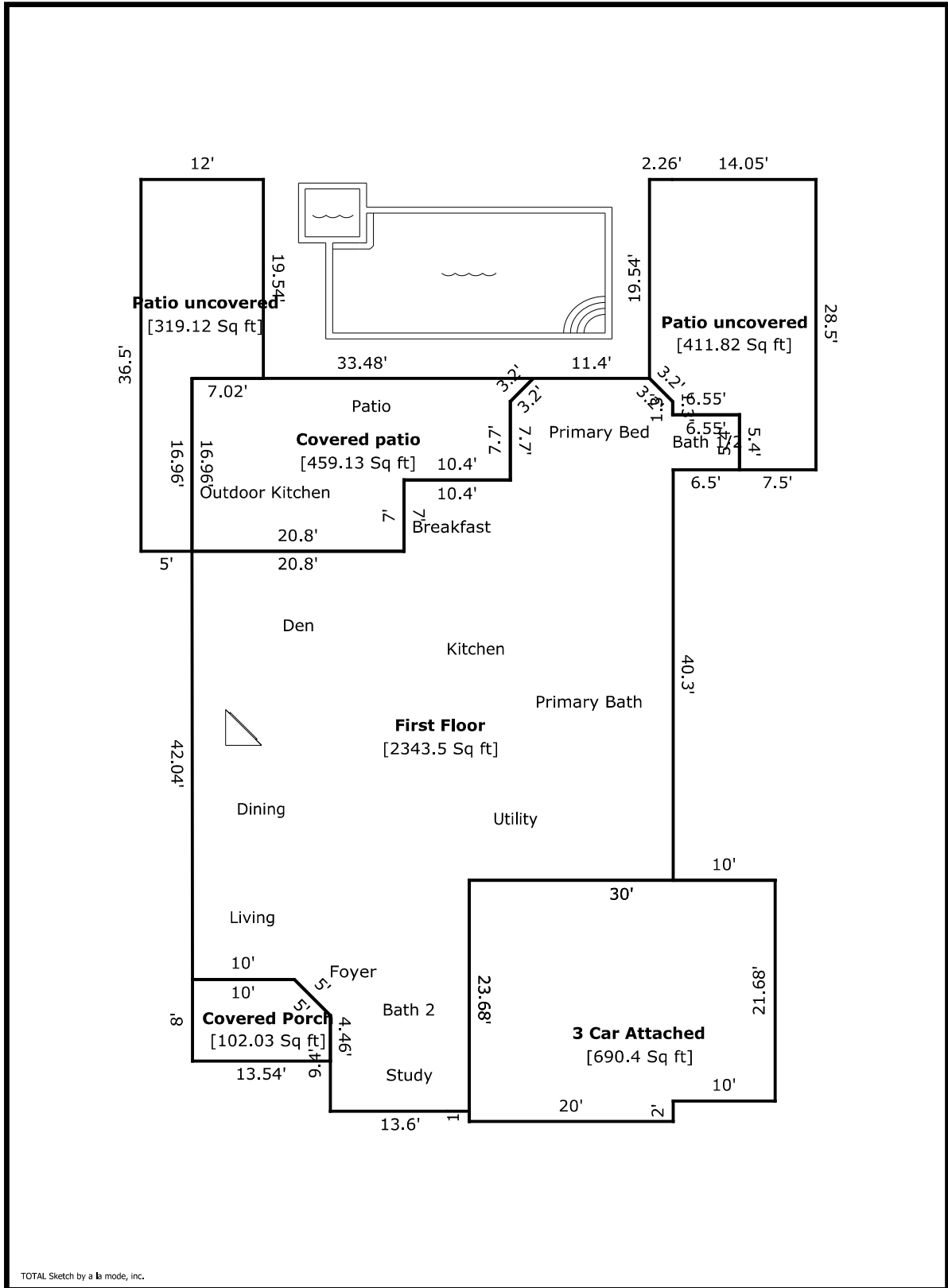

# Building Sketch (Page - 2)

Borrower/Client	Gina C Gudmundson						
Property Address	13315 Coolidge Creek Dr						
City	Tomball	County	Harris	State	TX	Zip Code	77377
Lender	HomeBridge Financial Services, Inc						

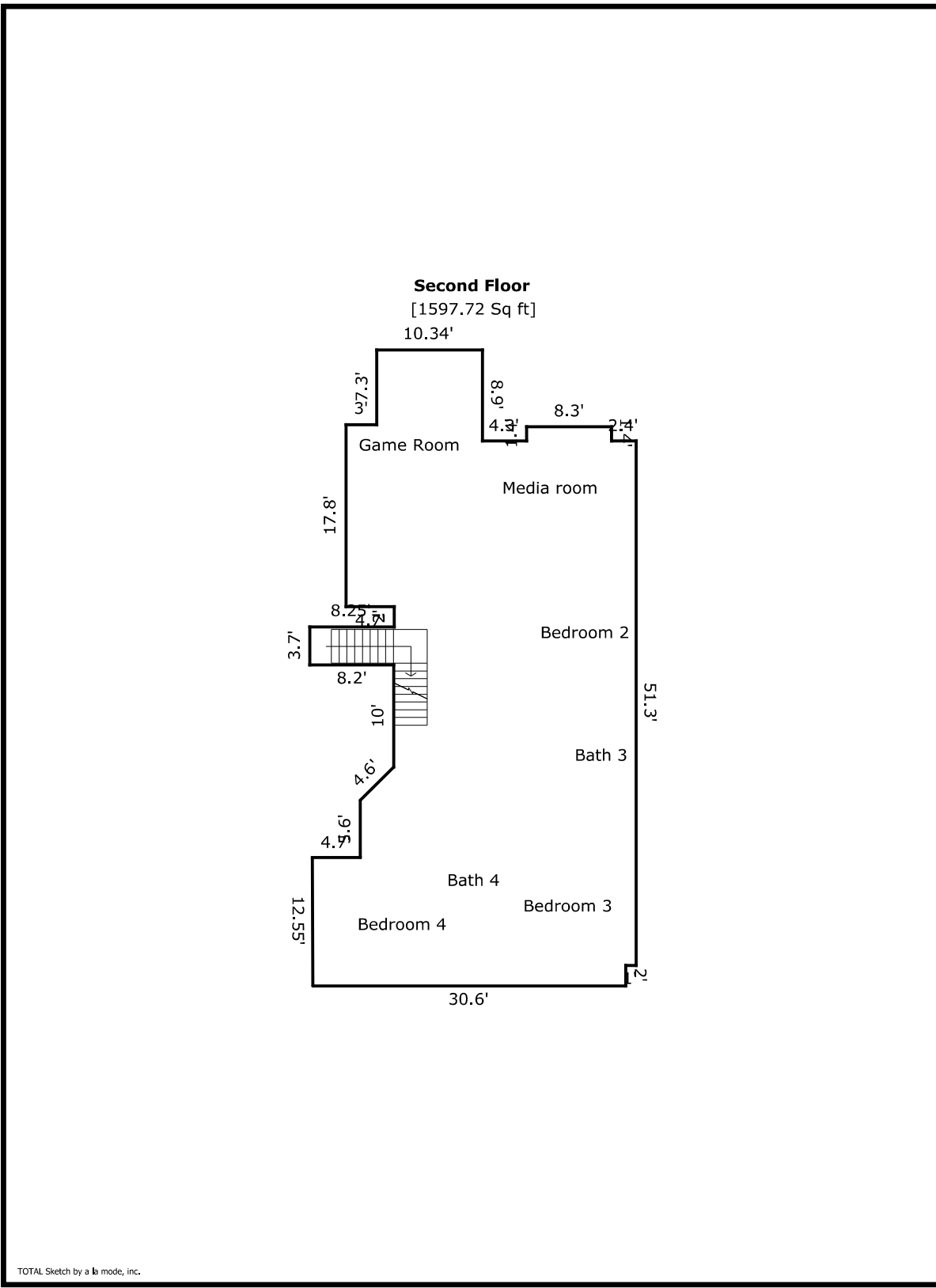

## Building Sketch (Page - 3)

Borrower/Client	Gina C Gudmundson		
Property Address	13315 Coolidge Creek Dr		
City	Tomball	County	Harris
		State	TX
		Zip Code	77377
Lender	HomeBridge Financial Services, Inc		

TOTAL Sketch by a la mode, inc.

### Area Calculations Summary

Living Area		Calculation Details
First Floor	2343,5 Sq ft	
		5,4 × 6,5 = 35,1
		13,6 × 9,4 = 127,84
		45,7 × 0,05 = 2,28
		13,6 × 3,54 = 48,08
		0,5 × 3,54 × 3,54 = 6,25
		27,14 × 9,74 = 264,42
		0,5 × 9,74 × 0,01 = 0,05
		47,09 × 32,3 = 1521,16
		0,5 × 32,3 × 0,03 = 0,5
		7 × 10,4 = 72,8
		15,93 × 14,7 = 234,1
		11,4 × 2,26 = 25,79
		0,5 × 2,26 × 2,26 = 2,56
		0,5 × 2,26 × 2,26 = 2,56
Second Floor	1597,71 Sq ft	
		8,3 × 1,4 = 11,62
		51,3 × 1 = 51,3
		53,3 × 14 = 746,2
		62,2 × 8,64 = 537,41
		35,1 × 0,05 = 1,76
		0,5 × 3,25 × 3,25 = 5,29
		18,15 × 3,25 = 59,03
		12,55 × 4,66 = 58,44
		0,5 × 12,55 × 0,04 = 0,27
		3,7 × 8,2 = 30,34
		25,1 × 1,7 = 42,67
		17,8 × 3 = 53,4
<b>Total Living Area (Rounded):</b>	<b>3941 Sq ft</b>	
<b>Non-living Area</b>		
3 Car Attached	690,4 Sq ft	
		23,68 × 20 = 473,6
		21,68 × 10 = 216,8
Covered patio	459,13 Sq ft	
		0,5 × 16,96 × 0,02 = 0,14
		16,96 × 20,8 = 352,82
		9,96 × 10,4 = 103,61
		0,5 × 2,26 × 2,26 = 2,56
Covered Porch	102,03 Sq ft	
		8 × 10 = 80
		3,54 × 4,46 = 15,78
		0,5 × 3,54 × 3,54 = 6,25
Patio uncovered	319,12 Sq ft	
		12 × 19,54 = 234,45
		16,96 × 4,98 = 84,54
		0,5 × 16,96 × 0,02 = 0,14
Patio uncovered	411,82 Sq ft	
		16,31 × 19,54 = 318,71
		8,96 × 7,5 = 67,22
		3,56 × 6,55 = 23,34
		0,5 × 2,26 × 2,26 = 2,56