

STAIR TOWER

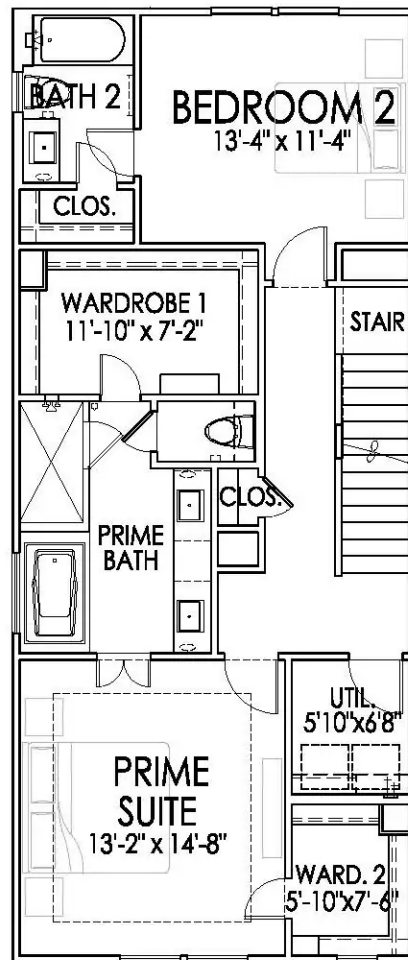

THIRD FLOOR



SECOND FLOOR

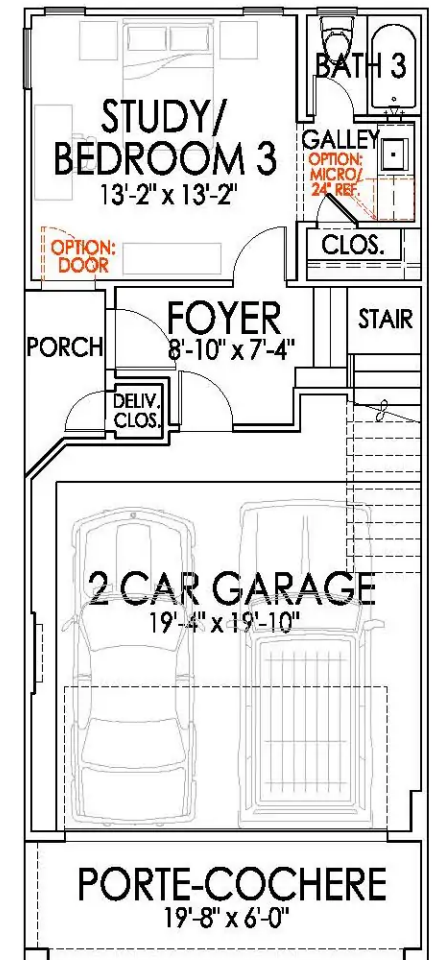

FIRST FLOOR

HARDY SKYLINE PLAN: 9430

PLANS BY:  CITYDESIGN  
Land Planning & Residential Design

**SQUARE FOOTAGES**

|               |           |
|---------------|-----------|
| FIRST FLOOR:  | 382       |
| SECOND FLOOR: | 796       |
| THIRD FLOOR:  | 947       |
| STAIR TOWER:  | 79        |
| TOTAL LIVING: | 2204 S.F. |