

GENERAL NOTES:

A. MASTER SCHEDULE: Refer to Master Schedule for finish and product 'Basis of Design'.

B. SYMBOLS: Refer to Project Information Sheet for legend of Reference Symbols and other graphic indicators/symbols.

B. DIMENSIONS: Dimensions are to face of finish material, unless noted otherwise. Dimensions to exterior walls are to finished face. Clear dimensions shall not vary and are measured at the floor line. Dimensions tied to column centerline shall set finished clear dimensions.

C. PARTITIONS:





1. All new partitions are to be perpendicular or parallel with core or exterior window wall elements, unless noted otherwise. Center partitions on columns or mullions, unless noted otherwise.
2. All partitions without a tag are to be Type A3.

D. DOOR: Hinge side of doors to be located 4" from nearest perpendicular partition, unless noted otherwise.

KEY NOTES:

1. RE: MILLWORK DRAWINGS BY SIEMATIC (OR HOMEOWNER ALTERNATE) FOR FINAL MILLWORK DESIGN AND SPECIFICS.
2. INSTALL BLOCKING IN THIS RESTROOM FOR N.I.C. ACCESSORIES AT TOILETS, SHOWERS, AND TUBS AS SHOWN ON A0.60
3. MILLWORK (BY OTHERS)
4. GAS FIREPLACE WITH HORIZONTAL FLUE TO BALCONY

ENLARGED INTERIOR UNIT PLAN FINISH LEGEND

-  WOOD FLOOR FINISH
-  TILE FLOOR FINISH
-  CARPET FLOOR FINISH
-  UNFINISHED FLOOR

PROJECT TEAM

PELICAN BUILDERS
OWNER

HENDERSON ROGERS
STRUCTURAL ENGINEER

THOMPSON COMPANY
MEP ENGINEER

HALFF ASSOCIATES
CIVIL ENGINEER

KUDELA WEINHEIMER
LANDSCAPE ARCHITECT

E.E. REED CONSTRUCTION
GENERAL CONTRACTOR

B.E.S.
ENVELOPE CONSULTANT

H.M.A. CONSULTING
SECURITY

WJHW
ACOUSTICAL

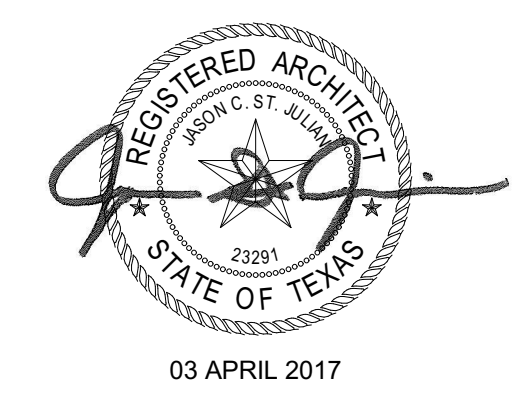

NO.	DATE	ISSUE
15	NOV 2016	LAYOUT REVIEW
14	DEC 2016	LAYOUT REVIEW
30	20 MAR 2017	PR #014

THE WILSHIRE

PROJECT ADDRESS
2047 WESTCREEK LANE
HOUSTON, TX 77027

PROJECT NO.
KIRKSEY PROJECT NO. **2014115**
KEY PLAN

SHEET TITLE
Enlarged Unit Plan: Unit 1603

SHEET NUMBER
A2.90_1603a
© 2017 Kirksey

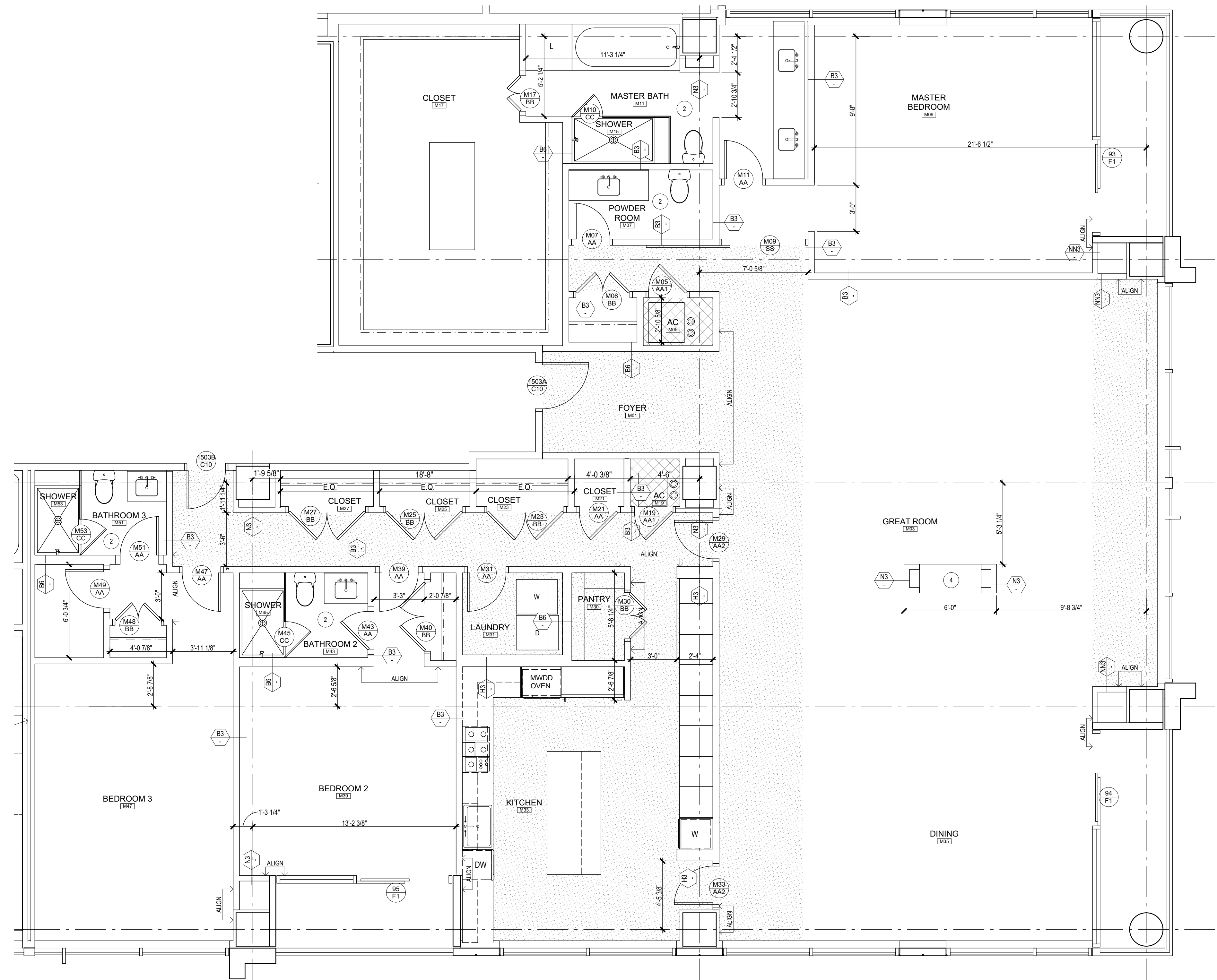

CEILING LEGEND

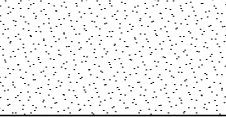
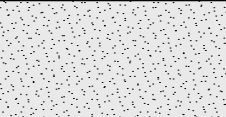
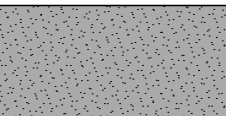
-  Gypsum board ceiling or furr-down.
9'-10" Ceiling Height U.N.O. (10'-10" on Levels 15-17).
Paint: PT-X
-  UNITS ONLY: Gypsum board ceiling or furr-down.
8'-10" Ceiling Height U.N.O. (9'-10" on Levels 15-17).
Paint: PT-X
-  UNITS ONLY: Gypsum board ceiling or furr-down.
8'-1" Ceiling Height U.N.O.
Paint: PT-X

LIGHTING FIXTURE SCHEDULE- BASE BUILDING								
TYPE	LOCATION	MANUFACTURER	PRODUCT NUMBER	MOUNTING	LAMPS	VOLTS	FIXTURE DEPTH	REMARKS
					NO./TYPE			
BA1	RESIDENCE INTERIOR AT CEILINGS (LIVING & BEDROOM)	ALLPRO	ET400ATS8 RL46WH830PK	RECESSED	14.3W LED	120	5-1/2"	
BA2	RESIDENCE INTERIOR SHOWER FIXTURE	ALLPRO	ET400ATS8 RL46WH830PK	RECESSED	13W LED	UNV	5-1/2"	0-10V DIMMING
BA3	RESIDENCE CLOSET	METALLUX	FMLED16WH830PR	RECESSED	23.6 LED	UNV	4-1/8"	0-10V DIMMING
BD	STEP LIGHT	PRIMA LIGHTING	8910-HL-SV-UN-30K	RECESSED WALL	2W LED			IP54 RATED

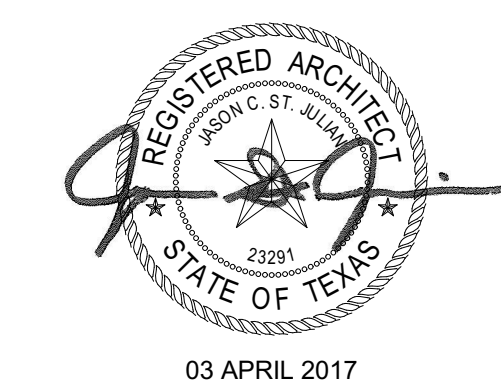
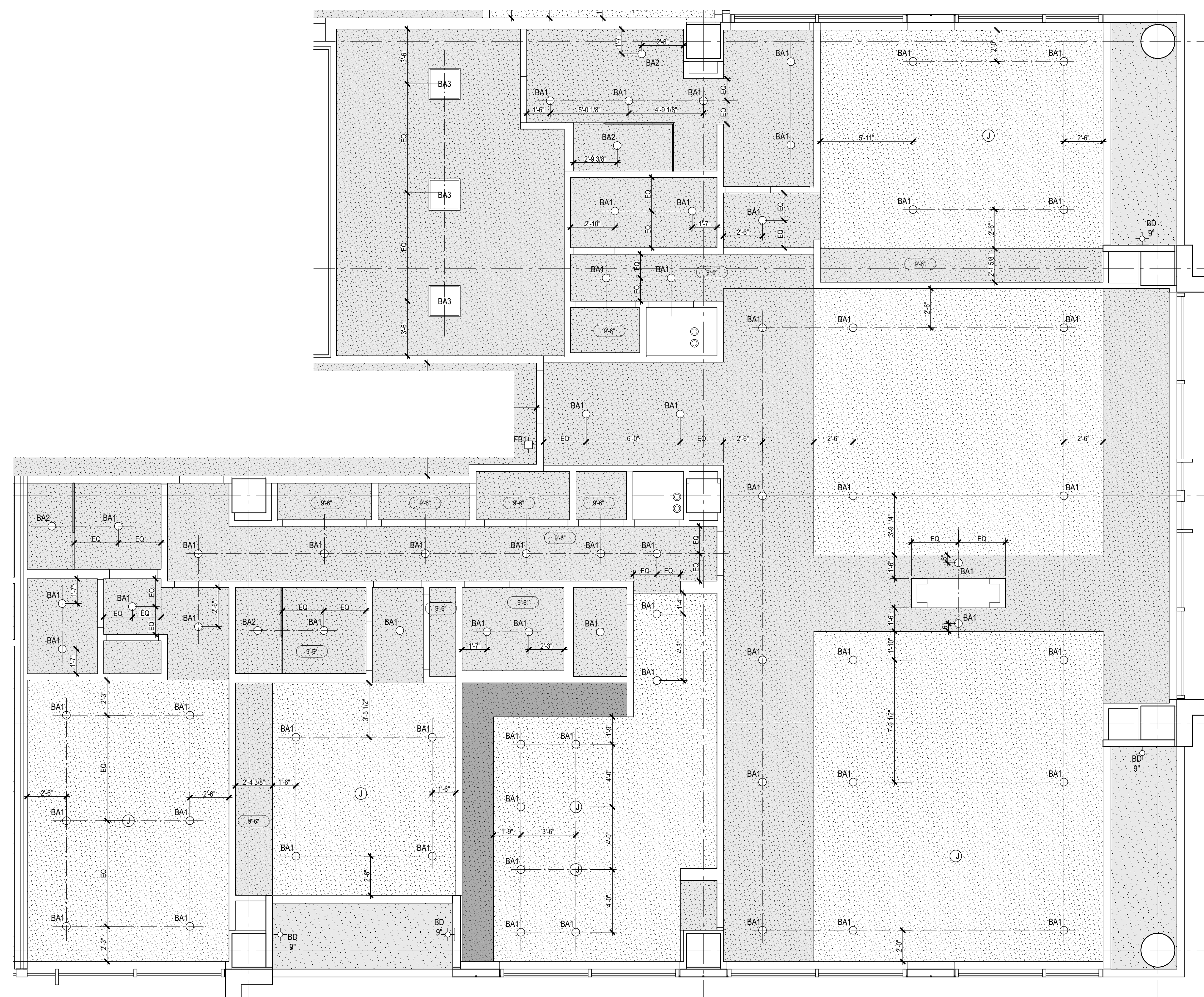

NO.	DATE	ISSUE
15	NOV 2016	LAYOUT REVIEW
14	NOV 2016	LAYOUT REVIEW
30	20 MAR 2017	PR #014



PROJECT ADDRESS
2047 WESTCREEK LANE
HOUSTON, TX 77027

PROJECT NO.
KIRKSEY PROJECT NO. 2014115
 KEY PLAN

SHEET TITLE
Enlarged Unit RCP: Unit 1603

SHEET NUMBER
A2.90_1603b
 © 2017 Kirksey