

NOTE:
 neighboring propane tank
 encroaches 1.7' onto
 subject property

NOTES:
 NO RECORDS SEARCH CONTRACTED. RECORD
 EASEMENTS, RESTRICTIONS, ROADWAYS,
 RIGHTS-OF-WAY, BUILDING LINES,
 ENCUMBRANCES, ETC. BY COMMON
 KNOWLEDGE ONLY.
 CLIENT HOLDS TLTS, INC. HARMLESS FROM
 RESPONSIBILITY FOR SAME

- PROPERTY SUBJECT TO STATE
 AND LOCAL RESTRICTIONS THAT
 MAY NOT COINCIDE WITH THOSE
 SHOWN ON THIS PLAT
- True ground distances shown
- Adjoining lot reference KAHALA
 BEACH ESTATES, ADDITION NO. 1,
 Vol 18, Pg 443, OCCGC
- Bearings assumed as platted
- FC #009-60-1779, OCCGC
- :5' front utility easement

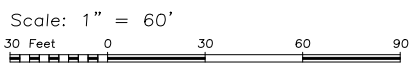

SITE PLAN of Lot 3-R, of "19011 Kahala Drive, a
 proposed replat of Lot 3, in Block 1, with Reserve "R"
 and Lot 4, in Block 1, with Reserve Q, in KAHALA BEACH
 ESTATES, ADDITION NO. 1, a subdivision in Galveston
 County, Texas, according to the map or plat thereof
 recorded in Volume 18, Page 443, in the Office of the
 County Clerk of Galveston County, Texas.

"open beach"
 remainder Division 2
 Section 11
 Hall & Jones Survey

Vacant property: Kahala Drive
 Galveston County, Texas

This survey is certified for this transaction only and may only be relied on
 by Donald H. Hausmann. This survey is only valid if print has original seal
 and signature of surveyor.

I hereby certify that this survey was made on the ground under my direct
 supervision and that this plat correctly represents the facts found at the
 time of the survey.

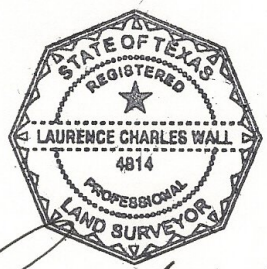

Laurence C. Wall

Laurence C. Wall
 RPLS #4814
 July 16, 2018

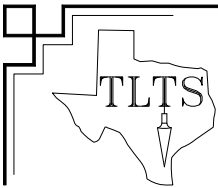

TLTS, Inc.
 TEXAS LAND TITLE SURVEYORS
 1801 Moody Avenue
 Galveston, Texas 77550
 (409) 765-8883