

BEARING BASIS:
 BEARINGS USED IN THIS SURVEY ARE BASED ON FOUND POINTS AND DEED REFERENCE CALLS ON THE SOUTH LINE OF THIS SURVEY

I EARL ROMERO JR. A R.P.L.S. IN THE STATE OF TEXAS DO HEREBY CERTIFY THAT THE ABOVE PLAT ACCURATELY DEPICTS THE ABOVE LOTS ACRES AND THAT THERE ARE NO EXCESSES, VACANCYS, OVERLAPPING OF IMPROVEMENTS, OR ENCHROACHMENTS UNLESS SHOWN ABOVE. THIS SURVEY IS ONLY CERTIFIED FOR BOUNDARY AND IMPROVEMENTS TO DATE FOR THIS TRANSACTION ONLY. SURVEYOR DID NOT ABSTRACT PROPERTY. EASEMENTS, BUILDING LINES, ETC., SHOWN HEREON ARE AS IDENTIFIED PER TITLE REPORT ISSUED BY:

AMERICAN TITLE CO. OF HOUSTON G.F.No. 08214374-085-WPC

ISSUE DATE: OCT. 17, 2001 EFFECTIVE: SEPT. 30, 2001

SURVEYED ON THE GROUND THIS DATE OCTOBER 30, 2001.

Earl Romero Jr.
 EARL A. ROMERO, JR.
 R.P.L.S.No. 3518

NOTE: PROPERTY IS SUBJECT TO THE TERMS AND AGREEMENTS OF THE RECORDED INSTRUMENTS AS FOLLOWS:
 1 BUILDING SET BACK LINE RECORDED IN VOL.4665 PG. 429

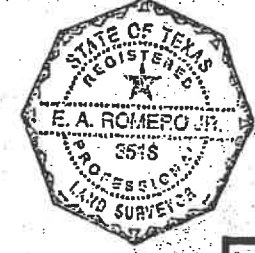

11/13/01

E.R. CONSULTANTS LAND SURVEYORS & ENGINEERS
 P.O. BOX 429, 1013 E. WALLISVILLE RD.
 HIGHLANDS, TEX. 77562 PH:281-428-0753 FAX:281-843-0778

SURVEY OF
 LOT 20, BLOCK 7,
 LAKE SHADOWS SUBD., SEC. 5
 HARRIS COUNTY, TEXAS.

SCALE 1"=20' DATE 10/30/01 JOB NO. 428 SHEET 11

LAKE BREEZE
 (60' R/W)

Scott W. P.