

- LEGEND:**
- WIRE FENCE
  - CHAINLINK FENCE
  - WROUGHT IRON FENCE
  - WOOD FENCE
  - VINYL FENCE
  - ELECTRIC LINE
  - GAS METER
  - ELECTRIC METER
  - IRON PIPE ROUND
  - IRON ROD SET
  - CONTROLLING MONUMENT (WOOD) RAILROAD TIE
  - ASPHALT
  - CONCRETE
  - GRAVEL
  - TILE
  - WOOD
  - BRICK
  - STONE

**LEGAL DESCRIPTION:**  
BEING LOT 3, OF OSCEOLA ADDITION, A SUBDIVISION IN HARRIS COUNTY, TEXAS, ACCORDING TO THE MAP OR PLAT THEREOF RECORDED IN VOLUME 480, PAGE 147, OF THE DEED RECORDS OF HARRIS COUNTY, TEXAS.

**SURVEYOR'S CERTIFICATION:**  
THIS IS TO CERTIFY THAT ON THIS DATE A SURVEY WAS MADE ON THE GROUND, UNDER MY SUPERVISION AND REFLECTS A TRUE AND CORRECT REPRESENTATION OF THE DIMENSIONS AND CALLS OF PROPERTY LINES AND LOCATION AND TYPE OF IMPROVEMENTS. THERE ARE NO VISIBLE AND APPARENT EASEMENTS, CONFLICTS, INTRUSIONS OR PROTRUSIONS, EXCEPT AS SHOWN. THIS SURVEY IS NOT TO BE USED FOR CONSTRUCTION PURPOSES AND IS FOR THE EXCLUSIVE USE OF THE HEREON NAMED PURCHASER, MORTGAGE COMPANY, AND TITLE COMPANY ONLY. AND THIS SURVEY IS MADE PURSUANT TO THAT CERTAIN TITLE COMMITMENT UNDER THE OF NUMBER SHOWN HEREON, PROVIDED BY THE TITLE COMPANY NAMED HEREON AND THAT THIS DATE, THE EASEMENTS, RIGHTS-OF-WAY OR OTHER LOCATABLE MATTERS OF RECORD THAT THE UNDERSIGNED HAS KNOWLEDGE OR HAS BEEN ADVISED ARE AS SHOWN OR NOTED HEREON. THIS SURVEY IS SUBJECT TO ANY AND ALL COVENANTS AND RESTRICTIONS PERTAINING TO THE RECORDED PLAT REFERENCED HEREON.

DATE: 09/15/2016  
FIELD: 09/14/2016  
JOB NO.: 16-07266

121 NORTH STREET, HOUSTON, TX 77009  
LOT 3, OSCEOLA ADDITION

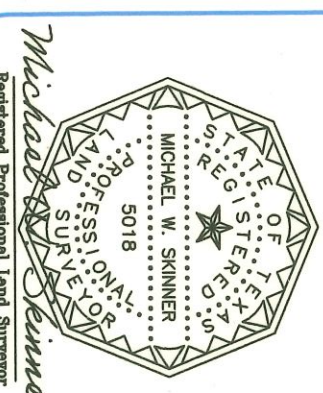

Michael W. Skinner  
Registered Professional Land Surveyor

**Premier Surveying LLC**  
5700 W. Plano Parkway  
Suite 2700  
Plano, Texas 75093  
972.612.3601 Office | 972.964.7021 Fax  
premier@sos.com | premierurveying.com  
www.premiersurveying.com



GF. NO.	7685-16-1102
BORROWER	JORGE E. GONZALEZ & MIRANDA L. WRIGHT
TECH	KG
FIELD	CS

**FLOOD INFORMATION:**  
THE SUBJECT PROPERTY DOES NOT APPEAR TO LIE WITHIN THE LIMITS OF A 100-YEAR FLOOD HAZARD ZONE ACCORDING TO THE MAP PUBLISHED BY THE FEDERAL EMERGENCY MANAGEMENT AGENCY, AND HAS A ZONE "X" RATING AS SHOWN BY MAP NO. 48201C0690 M, DATED JUNE 9, 2014.

