

SCALE: 1" = 20'

NOTES:

1. ALL BEARINGS SHOWN HEREON ARE BASED ON THE RECORDED PLAT.
2. ALLPOINTS LAND SURVEY, INC. IS NOT LIABLE FOR ANY DAMAGES DUE TO INFORMATION NOT PROVIDED TO SURVEYOR OR BUILDER PLACING ANY IMPROVEMENTS WITHIN A BUILDING LINE OR EASEMENT.
3. ALL SET RODS ARE 5/8" I.R. WITH CAP MARKED "ALLPOINTS SURVEY".
4. SUBJECT TO APPLICABLE RESTRICTIVE COVENANTS LISTED IN ITEM 1, SCHEDULE "B" OF TITLE COMMITMENT ISSUED BY STEWART TITLE GUARANTY UNDER G.F. No 2046265.
5. AGREEMENT FOR UNDERGROUND ELECTRIC SERVICES PER G.F. No. 2022044809.
6. ALL FOUND IRON RODS ARE CAPPED WITH PLASTIC CAPS MARKED "GBI" UNLESS OTHERWISE NOTED.
7. SHORT FORM BLANKET EASEMENT FOR CERTAIN UTILITIES PER G.E. No. 2022065934.

"THIS INFORMATION IS BASED ON GRAPHIC PLOTTING. WE DO NOT ASSUME RESPONSIBILITY FOR EXACT DETERMINATION"

I HEREBY CERTIFY THAT THIS PLAT REPRESENTS THE RESULTS OF A SURVEY MADE ON THE GROUND, ON THE 13TH DAY OF OCTOBER, 2023.

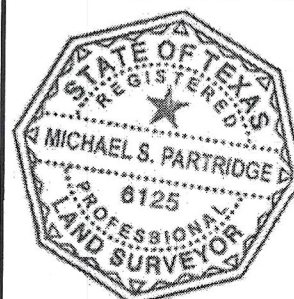

©2023, ALLPOINTS LAND SURVEY, INC.  
All Rights Reserved.

ALLPOINTS LAND SURVEY, INC. - 1515 WITTE ROAD - HOUSTON, TEXAS 77080 - PHONE: 713-468-7707 - T.B.P.E.L.S. # 10122600