

*Russell L. Brink* 9/25/14  
*Naureen S. Ahmeduddin* 9/25/14

**BELLEVUE FALLS LANE**  
 (50' R.O.W.)

- NOTES:
1. ALL BEARINGS SHOWN HEREON ARE BASED ON THE RECORDED PLAT.
  2. SUBJECT TO APPLICABLE RESTRICTIVE COVENANTS LISTED IN ITEM No. 1 SCHEDULE "B" OF TITLE COMMITMENT ISSUED BY FIRST AMERICAN TITLE INSURANCE Co. UNDER G.F. No. 110-14000542-TBI.
  3. AGREEMENT FOR UNDERGROUND ELECTRIC SERVICE PER C.F. No. 2013042132.

**PLAT OF SURVEY**  
 SCALE: 1" = 20'

FLOOD MAP:  
 THIS PROPERTY LIES IN ZONE "X SHADED"  
 AS DEPICTED ON COMMUNITY PANEL  
 No. 48157 C 0265 J, DATED: 01-03-97  
 Per LOMR 11-06-0225P, DATED 07-05-12

"THIS INFORMATION IS BASED ON GRAPHIC PLOTTING. WE DO NOT ASSUME RESPONSIBILITY FOR EXACT DETERMINATION"

© 2014, ALLPOINTS SERVICES, CORP., All Rights Reserved. This original work is protected under copyrights laws, Title 17 U.S. Code Sections 101 & 102. All violators will be prosecuted to the extent of the law. This survey is being provided solely for the use of the recipients and no license has been created, express or implied, to copy the survey except as is necessary in conjunction with the original transaction.

FOR: RUSSELL L. BRINK AND  
 NAUREEN S. AHMEDUDDIN  
 ADDRESS: 5020 BELLEVUE  
 FALLS LANE  
 ALLPOINTS JOB #: TB69549 CM  
 G.F.: 110-14000542-TBI

LOT 4, BLOCK 1,  
 OLIVE HILL AT RIVERSTONE,  
 PLAT No. 20130023, PLAT RECORDS,  
 FORT BEND COUNTY, TEXAS

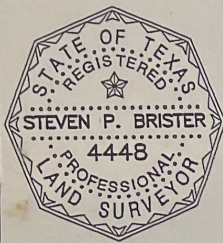

I HEREBY CERTIFY THAT THIS PLAT REPRESENTS THE RESULTS OF A SURVEY MADE ON THE GROUND, ON THE 19TH DAY OF AUGUST, 2014.

*Steven P. Brister*



**ALLPOINTS SERVICES CORP.**  
 PHONE: 713-468-7707  
 FAX: 713-827-1861