

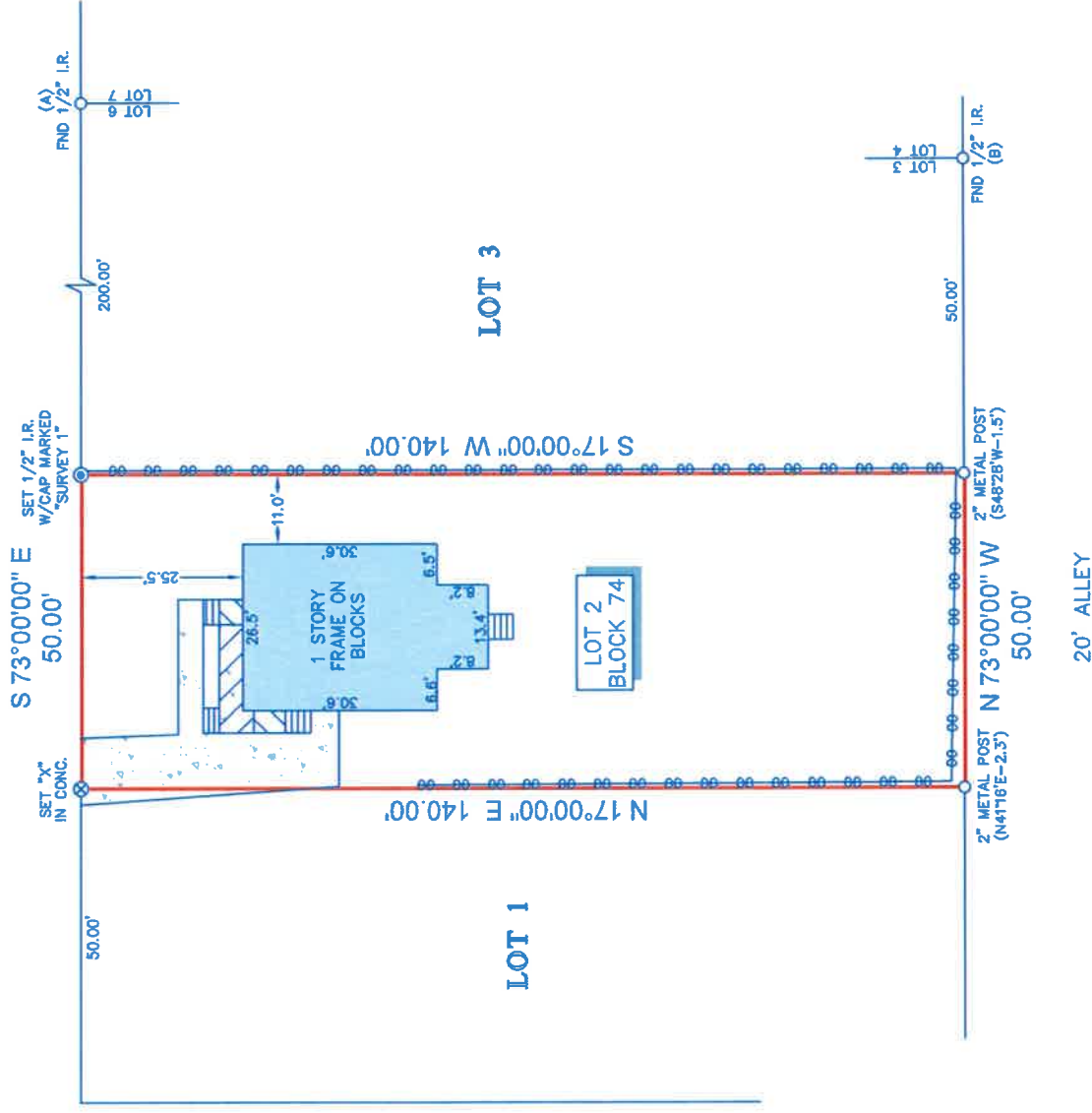

TITLE COMPANY:
Texas American
TITLE COMPANY
 832-775-1157
 ISSUE DATE: OCTOBER 10, 2023
 G.F. #: 2782523-06548



WEST 6TH STREET
 (PLATTED AS FIFTH STREET)
 (60' R.O.W.)



HICKORY STREET
 (60' R.O.W.)

NOTES:

1. ALL BEARINGS SHOWN HEREON ARE REFERENCED TO THE SUBDIVISION PLAT NAMED BELOW, POINTS (A) AND (B) WERE HELD FOR HORIZONTAL CONTROL.
2. ABSTRACT INFORMATION FOR THE SUBJECT TRACT WAS PROVIDED BY THE TITLE INSURANCE COMPANY LISTED ABOVE, SURVEYOR HAS NOT INDEPENDENTLY ABSTRACTED SUBJECT PROPERTY.
3. THIS SURVEY IS CERTIFIED TO THE TITLE INSURANCE COMPANY LISTED ABOVE FOR THIS TRANSACTION ONLY, IT IS NOT TRANSFERABLE TO ADDITIONAL INSTITUTIONS OR SUBSEQUENT OWNERS.
4. ALL EASEMENTS AND BUILDING LINES SHOWN ARE PER THE RECORDED PLAT UNLESS OTHERWISE NOTED.
5. THERE ARE NO NATURAL DRAINAGE COURSES ON SUBJECT PROPERTY.
6. SUBJECT TO THE RESTRICTIVE COVENANTS AS LISTED IN SCHEDULE B OF THE TITLE COMMITMENT ISSUED ON OCTOBER 10, 2023, UNDER G.F. NO. 2782523-06548.

LEGEND

	STEPS		ELEVATED CONCRETE
	CONCRETE		FENCE
	COVERED AREA		CHAIN

LEGAL DESCRIPTION: LOT 2, BLOCK 74, OF FREEPORT, A SUBDIVISION IN BRAZORIA COUNTY, TEXAS ACCORDING TO THE MAP OR PLAT THEREOF, RECORDED IN VOLUME 2, PAGE 95 OF THE MAP RECORDS OF BRAZORIA COUNTY, TEXAS.

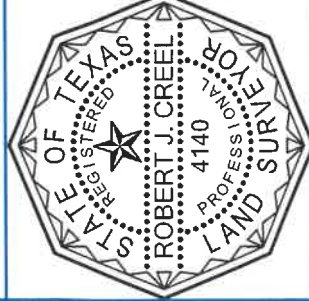

SURVEYORS CERTIFICATE:
 IN MY PROFESSIONAL OPINION, THIS PLAT REPRESENTS THE FACTS FOUND ON THE GROUND DURING THE COURSE OF A BOUNDARY SURVEY CONDUCTED UNDER MY SUPERVISION ON OCTOBER 11, 2023 AND THAT THIS PLAT SUBSTANTIALLY COMPLES WITH THE CURRENT STANDARDS AS ADOPTED BY THE TEXAS BOARD OF PROFESSIONAL LAND SURVEYING AND THAT THERE ARE NO ENCROACHMENTS OR PROTRUSIONS EXCEPT AS SHOWN.

Robert J. Creel
 ROBERT J. CREEL
 RPLS# 4140

CLIENT: SANKET BHARATKUMA PATEL
 ADDRESS: 527 WEST 6TH STREET

www.survey1inc.com
 survey1@survey1inc.com

 Your Land Survey Company
 Firm Registration No. 100758-00
 P.O. Box 2543 | Alvin, TX 77512 | (281)393-1382

FIELD CREW:	N/A	TECH:	ET
DRAFTER:	MC(V)	FINAL CHECK:	EF
DATE:	OCT. 13, 2023		
JOB#	10-128616-23		